

Feasibility Report for Westwood Lake Water Quality Improvement Project

St. Louis Park, MN

May 2018



Prepared for
Bassett Creek Watershed Management Commission



Feasibility Report for Westwood Lake Water Quality Improvement Project

St. Louis Park, MN

May 2018



Prepared for
Bassett Creek Watershed Management Commission



Feasibility Report for Westwood Hills Nature Center

May 2018

Contents

| | | |
|-------|---|----|
| 1.0 | Background | 1 |
| 1.1 | Project Area Description | 1 |
| 1.1.1 | Westwood Lake | 1 |
| 1.1.2 | Westwood Lake Subwatershed | 2 |
| 1.1.3 | Turtle Pond | 2 |
| 1.1.4 | Wetland Delineation | 3 |
| 1.1.5 | Soil Borings | 3 |
| 1.2 | Hydrologic and Hydraulic Models | 3 |
| 1.3 | Water Quality Models | 3 |
| 2.0 | Goals and Objectives | 7 |
| 2.1 | Scope | 7 |
| 2.2 | Considerations | 8 |
| 3.0 | Stakeholder Input | 8 |
| 3.1 | Public Stakeholder Meeting | 8 |
| 3.2 | Technical Stakeholder Meeting | 8 |
| 3.3 | BCWMC Stakeholder Comments | 9 |
| 4.0 | Water Quality Improvement Concepts | 9 |
| 4.1 | Concept 1 – Additional Permeable Pavers | 9 |
| 4.2 | Concept 2 – Expand Filtration Basins | 10 |
| 4.3 | Concept 3 – Linear Water Feature | 11 |
| 4.4 | Concept 4 – Heated Sidewalks | 12 |
| 4.5 | Concept 5 – Water Reuse | 13 |
| 5.0 | Water Quality Impacts | 18 |
| 6.0 | Project Cost Considerations | 18 |
| 6.1 | Opinion of cost | 18 |
| 6.2 | Concept 3 Potential Cost Reduction | 19 |
| 6.3 | Funding Sources | 19 |
| 6.4 | Project Schedule | 19 |

| | | |
|-----|--|----|
| 7.0 | Permitting, Site Impacts, and Coordination | 21 |
| 7.1 | Permitting | 21 |
| 7.2 | Site Impacts..... | 21 |
| 7.3 | Coordination..... | 21 |
| 8.0 | Recommendations | 21 |
| 9.0 | References | 21 |

List of Tables

| | | |
|-----------|---|----|
| Table 5-1 | Estimated Annual TSS and TP Removals for Concepts 1, 2, and 3..... | 18 |
| Table 6-1 | Estimated Capital and Annualized Costs for Concepts 1, 2, 3, and 4..... | 20 |

List of Figures

| | | |
|------------|---|----|
| Figure 1-1 | BCWMC Major Subwatersheds and Drainage Patterns | 4 |
| Figure 1-2 | Westwood Hills Nature Center Location and Land Use | 5 |
| Figure 1-3 | Westwood Hills Nature Center - Existing Conditions and Proposed Conditions..... | 6 |
| Figure 4-1 | Concept 1: Additional Permeable Pavers | 14 |
| Figure 4-2 | Concept 2: Expand Filtration Basins..... | 15 |
| Figure 4-3 | Concept 3: Linear Water Feature | 16 |

List of Appendices, Attachments, or Exhibits

| | |
|------------|---|
| Appendix A | Westwood Hills Nature Center Site Topographic and Tree Survey |
| Appendix B | Soil Borings |
| Appendix C | Cost Estimates |

Certifications

I hereby certify that this plan, specification, or report was prepared by me or under my direct supervision and that I am a duly Licensed Professional Engineer under the laws of the state of Minnesota.



Michelle Kimble
PE #: 42012

May 9, 2018

Date

1.0 Background

The BCWMC's 2015-2025 Watershed Management Plan (Plan, Reference (1)) addresses the need to improve the quality of stormwater runoff reaching the Mississippi River by reducing nonpoint source pollution, protecting and enhancing fish and wildlife habitat, reducing stormwater runoff volume to improve water quality, and taking into account aesthetics and recreational opportunities within the watershed. This project is consistent with the goals (Section 4.1) and policies (Sections 4.2.1 and 4.2.10) in the Plan. The Plan's 10-year Capital Improvement Program (CIP, Table 5-3 in the Plan) includes project WST-2 Westwood Lake Water Quality Improvement Project. The BCWMC approved the 5-year (working) CIP at their March 17, 2016 meeting, which included implementation of the Westwood Lake Water Quality Improvement Project in 2019.

The Westwood Lake Water Quality Improvement Project is part of a larger project at the Westwood Hills Nature Center (WHNC). The City of St. Louis Park is in the planning phase of a complete reconstruction of its facilities in 2019. A master plan for the reconstruction project was completed in May 2016 for the City of St. Louis Park. The proposed improvements in the master plan include trail circulation and wayfinding, additional parking, expanded outdoor classroom area and water garden, expanded natural play and outdoor education area, interpretive features, and a new interpretive center building. This study examines the feasibility of constructing additional water quality improvements (that would go above and beyond stormwater treatment that is required by the development project) to treat stormwater runoff that would otherwise flow untreated to Westwood Lake.

1.1 Project Area Description

The WHNC is a 160-acre park located in St. Louis Park in the southern portion of the Bassett Creek watershed, southeast of the intersection of Interstate 394 and Highway 169 (Figure 1-1). The park is bordered by Westwood Hills Drive, Virginia Avenue South, and Westwood Hills Road on the east; and Westmoreland Lane and Flag Avenue South on the south and west. Wayzata Boulevard is north of the park. The park contains trails, marsh, woods, and restored prairie, and is surrounded by medium density residential and commercial areas (Figure 1-2). The existing interpretive center at the WHNC is located in the southeast portion of the park, approximately 360 feet north of the existing parking lot, and is accessed via a paved trail from the parking lot. The existing interpretive center will be deconstructed as part of the larger WHNC reconstruction project and the new interpretive center will be built near the north edge of the existing parking lot. The existing parking lot will be demolished and reconstructed farther to the south. The new facility will be nearly five times as large as the existing building. The existing parking lot has 33 parking spaces and the proposed parking lot will provide nearly double the number of parking spaces (Figure 1-3).

1.1.1 Westwood Lake

Westwood Lake is a 38-acre lake in St. Louis Park in the southern portion of the Bassett Creek watershed. The BCWMC classified Westwood Lake as a Priority 1 shallow lake, making this water quality improvement project eligible for inclusion in the BCWMC's CIP. Westwood Lake has a maximum depth of 5 feet, a

normal water elevation of 887.6 feet (NAVD88 datum), and a 100-year elevation of 890.0 feet (NAVD88 datum).

Runoff draining into the lake enters through five storm sewers located around the perimeter. On the north side of the lake, the outlet is a 400-foot long open channel which discharges to a 27-inch reinforced concrete pipe (RCP) storm sewer at an elevation of 886.2 feet (NAVD88 datum). From there runoff drains through several ponds and pipes over 1500 feet in length, and outlets into the main stem of Bassett Creek, downstream of General Mills Boulevard.

Westwood Lake's water quality, including total phosphorus concentrations, meets Minnesota Pollution Control Agency (MPCA) water quality standards for shallow lakes in the north central hardwood forest ecoregion; therefore, the lake is not included on the MPCA's 303(d) List of Impaired Waters. Westwood Lake also meets the MPCA standards for specific conductance (when chloride measurements are not available, specific conductance is used as a surrogate for chloride).

Specific conductance in Westwood Lake has remained relatively stable over time, ranging from about 400 to 500 $\mu\text{mhos/cm}$ @ 25°C during 2011 and 2015, well below the MPCA standard of 1,000 $\mu\text{mhos/cm}$ @ 25°C. Although chlorides have not been measured in Westwood Lake, chloride concentrations can be estimated by using a relationship between specific conductance and chlorides documented for Nine Mile Creek. Using that relationship, the estimated chloride concentrations in Westwood Lake during 2011 and 2015 ranged from about 40 to 50 mg/L, well below the MPCA chronic standard of 230 mg/L. (Study, Reference (2))

In 2015, *Lynchnothamnus barbaratus* (bearded stonewort) was observed in Westwood Lake. This was the first known occurrence of this plant in Minnesota. Bearded stonewort and other the two other dominant plant species in the lake, fetid stonewort (*Chara contraria*) and coontail (*Ceratophyllum demersum*), are strong nutrient absorbers and likely contribute to the good water quality in the lake. (Study, Reference (2))

1.1.2 Westwood Lake Subwatershed

Westwood Lake's 463-acre watershed includes portions of St. Louis Park, Golden Valley, and Minnetonka. The watershed primarily comprises low-density residential land use, park and recreational areas, and a golf course (Figure 1-2). The lake is adjacent to parkland and within the WHNC, both of which provide access to trails surrounding the lake and opportunities for canoeing or kayaking, scenic viewing, birding, and hiking. The project area is generally flat or moderately undulating, with the exception of a steep hilly area near the existing WHNC interpretive center. Adjacent upland areas east of the parking lot have steep topography. A detailed topographic map can be found in Appendix A.

1.1.3 Turtle Pond

Turtle Pond is a small wetland located northwest of the proposed WHNC interpretive center building. The Turtle Pond outlet is a 12-inch polyvinyl chloride (PVC) culvert with an invert elevation of 889.4. Turtle Pond drains into a small unnamed wetland which then drains into Westwood Lake via an 8-inch PVC culvert with an invert elevation of 888.6 (Figure 1-3).

1.1.4 Wetland Delineation

The City of St. Louis Park, in coordination with HGA Architects and Engineers (HGA), completed a site topographic and tree survey, wetland delineation, and Phase 1 environmental site assessment in 2017 as part of the larger WHNC reconstruction project. The site topographic and tree survey, which shows the wetland locations, was provided by HGA and is included in Appendix A.

1.1.5 Soil Borings

The City of St. Louis Park, in coordination with HGA, completed soil borings in 2017 for the proposed WHNC reconstruction project. Soils are generally characterized as fill, swamp deposits, peat, or clay with groundwater seven to ten feet below grade. The Soil boring logs were provided by HGA and are included in Appendix B.

1.2 Hydrologic and Hydraulic Models





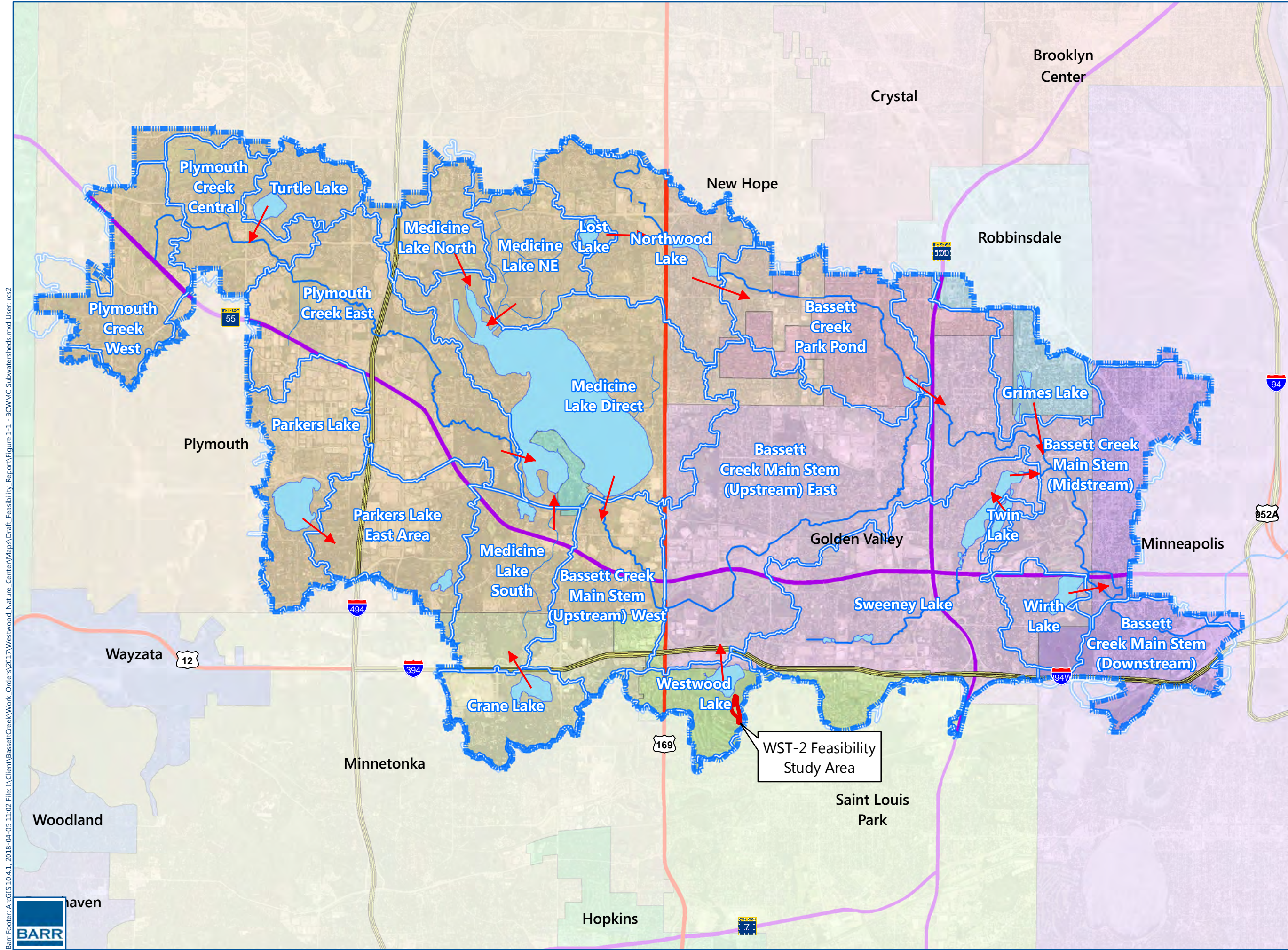

The BCWMC completed the Phase II XP-SWMM model for Bassett Creek and its contributing watersheds in 2016. Hydrologic and hydraulic information was not reviewed or analyzed as part of this feasibility study because no changes are proposed that would impact the information included in the XP-SWMM model.

1.3 Water Quality Models

The BCWMC developed the P8 model for Bassett Creek and its contributing watersheds in 2012. The P8 water quality model was not reviewed or analyzed as part of this feasibility study, however this study included a preliminary MIDS and water balance analysis to estimate the water quality improvement expected from each proposed alternative. Final design efforts should include both additional refinements to the water quality modeling as the design components are finalized and incorporation of the constructed improvements into the BCWMC's P8 model after completion of the project.

Barr Footer: ArcGIS 10.4.1, 2018-04-05 11:02 File: I:\Client\BassettCreek\Work_Orders\2017\Westwood Nature Center\Maps\Draft_Feasibility_Report\Figure 1-1 - BCWMC Subwatersheds.mxd User: rcs2



-  Flow Directions
-  BCWMC Priority Streams
-  WST-2 Feasibility Study Area
-  Major Subwatersheds
-  Lakes and Ponds
-  BCWMC Jurisdictional Boundary

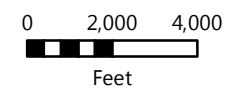









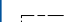

BCWMC
 MAJOR SUBWATERSHEDS
 AND DRAINAGE PATTERNS
 Westwood Hills
 Nature Center

FIGURE 1-1



Barr Footer: ArcGIS 10.4.1, 2018-03-29 13:56 File: \\barr.com\gis\client\BassettCreek\Work_Orders\2017\Westwood_Nature_Center\Maps\Draft_Feasibility_Report\Figure 1-1 - Location and Land Use.mxd User: rcs2



-  Creeks
 -  WST-2 Feasibility Study Area
 -  Westwood Hills Nature Center
- 2016 Generalized Land Use (Met Council)**
-  Open Water
 -  Retail and Other Commercial
 -  Office
 -  Institutional
 -  Residential
 -  Park, Recreational, or Preserve
 -  Golf Course

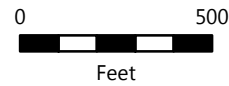

LOCATION AND LAND USE
 Westwood Hills Nature Center
 Bassett Creek Watershed Management Commission

FIGURE 1-2



CADD USER: Josh Phillips FILE: M:\DESIGN\23270051_4023270051_40_EXISTING_VS_PROPOSED.DWG PLOT SCALE: 1:2 PLOT DATE: 4/11/2018 3:34 PM
 BARR M:\AutoCAD 2011\AutoCAD 2011\Support\template\Barr_2011_Template.dwt Plot at 1: 10/05/2010 14:03:50

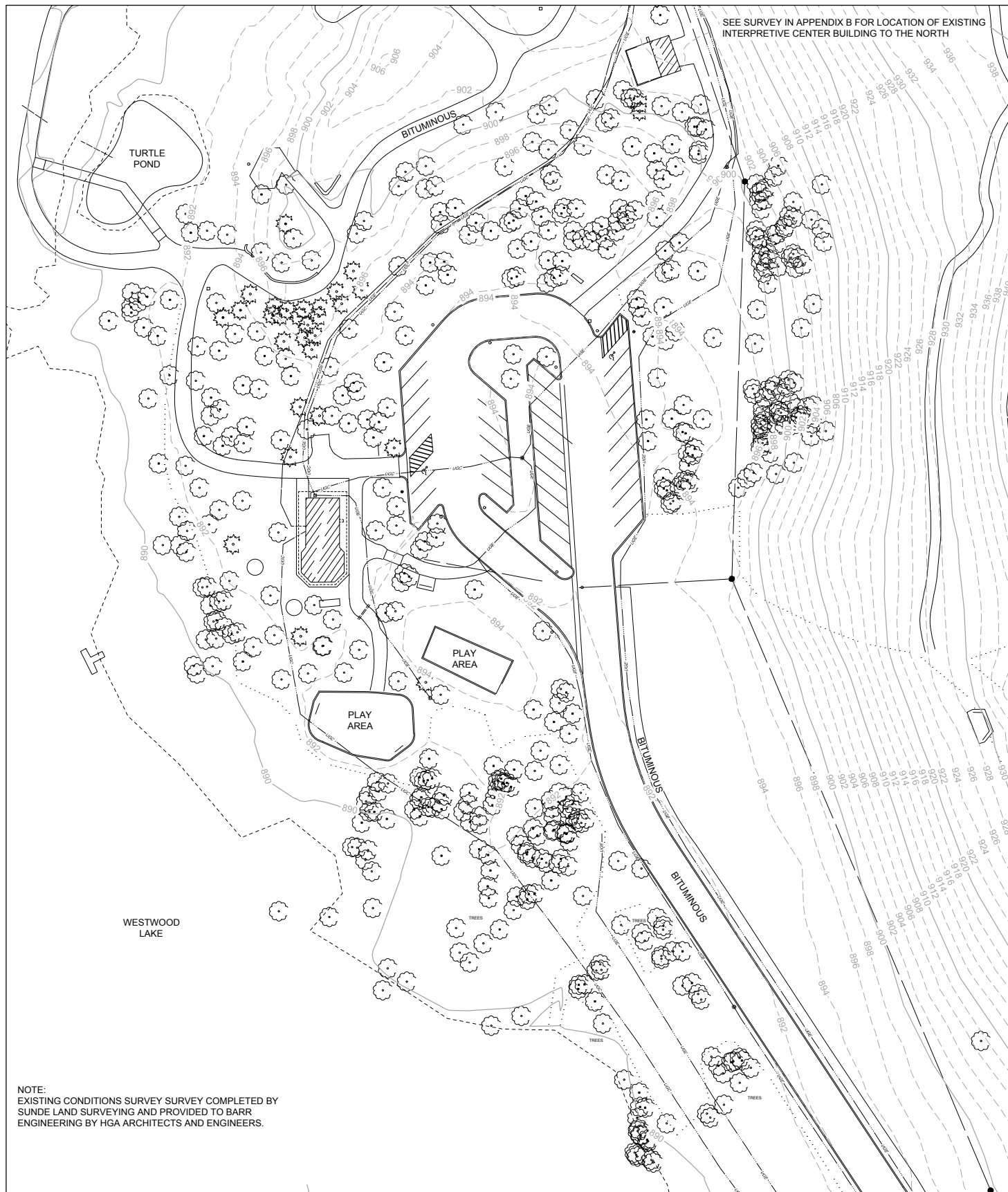

1 PLAN: EXISTING CONDITIONS
SCALE AS SHOWN

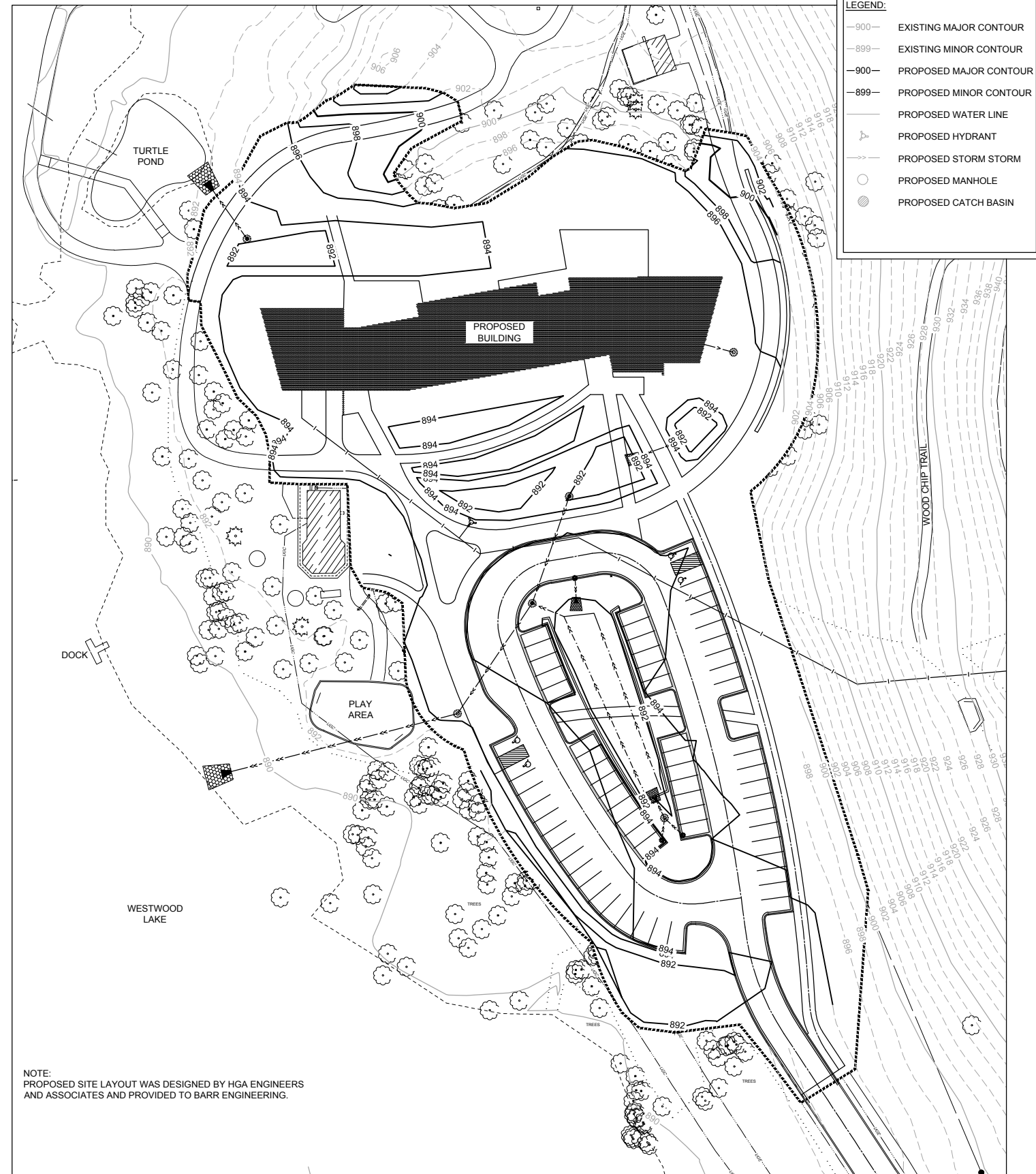
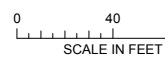

2 PLAN: PROPOSED CONDITIONS
SCALE AS SHOWN

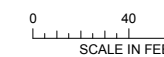

ISSUED FOR REVIEW
NOT FOR CONSTRUCTION

| NO. | BY | CHK | APP | DATE | REVISION DESCRIPTION |
|-----|-----|-----|-----|------------|-----------------------|
| A | JPP | MAK | KLC | 04/11/2018 | BCWMC AND CITY REVIEW |

I HEREBY CERTIFY THAT THIS PLAN, SPECIFICATION, OR REPORT WAS PREPARED BY ME OR UNDER MY DIRECT SUPERVISION AND THAT I AM A DULY LICENSED PROFESSIONAL ENGINEER UNDER THE LAWS OF THE STATE OF MINNESOTA.

PRINTED NAME: _____
 SIGNATURE: _____
 DATE: _____ LICENSE #: _____

| CLIENT | 04/11/18 |
|-----------------|---------------|
| BID | |
| CONSTRUCTION | |
| RELEASED TO/FOR | A B C 0 1 2 3 |
| DATE RELEASED | |

BARR Project Office:
 BARR ENGINEERING CO.
 4300 MARKETPOINTE DRIVE
 Suite 200
 MINNEAPOLIS, MN 55435
 Corporate Headquarters:
 Minneapolis, Minnesota
 Ph: 1-800-632-2277
 Fax: (952) 832-2601
 www.barr.com

| Scale | AS SHOWN |
|----------|------------|
| Date | 04/11/2018 |
| Drawn | JPP |
| Checked | MAK |
| Designed | |
| Approved | KLC |

BCWMC

WESTWOOD LAKE WATER QUALITY IMPROVEMENT PROJECT (WST-2)

EXISTING CONDITIONS AND PROPOSED CONDITIONS

BARR PROJECT No. 23/27-0051.40
 CLIENT PROJECT No. _____
 DWG. No. FIGURE 1-3
 REV. No. A

2.0 Goals and Objectives

The goals and objectives of the feasibility study are to:

1. Review the feasibility of improving quality of stormwater runoff reaching Westwood Lake.
2. Develop conceptual designs.
3. Provide an opinion of cost for design and construction of concepts.
4. Identify potential impacts and permitting requirements.

The goals and objectives of the water quality project is to:

1. Reduce nonpoint source pollution
2. Protect and enhance fish and wildlife habitat at WHNC
3. Reduce stormwater runoff volume
4. Prevent erosion of soil into Westwood Lake and surrounding wetlands
5. Consider aesthetics and recreational opportunities at WHNC
6. Increase the quality of wetlands

2.1 Scope

As part of the larger WHNC reconstruction project, the City of St. Louis Park is proposing to construct additional water quality improvements to treat stormwater runoff that would otherwise flow untreated to Westwood Lake. The BCWMC's WST-2 CIP project funding would be applied towards the portions of the water quality improvements that provide treatment "above and beyond" the BCWMC requirements for the WHNC reconstruction project.

This project is consistent with the goals (Section 4.1) and policies (Sections 4.2.1, 4.2.2, and 4.2.10) in the 2015 – 2025 BCWMC Watershed Management Plan. The BCWMC has included the Westwood Hills Nature Center Water Quality Project in its CIP, based on gatekeeper policy 110 from the BCWMC Plan:

The BCWMC will consider including projects in the CIP that meet one or more of the following "gatekeeper" criteria.

- *Project is part of the BCWMC trunk system (see Section 2.8.1, Figure 2-14 and Figure 2-15)*
- *Project improves or protects water quality in a priority waterbody*
- *Project addresses an approved TMDL or watershed restoration and protection strategy (WRAPS)*
- *Project addresses flooding concern*

The BCWMC will use the following criteria, in addition to those listed above, to aid in the prioritization of projects:

- *Project protects or restores previous Commission investments in infrastructure*
- *Project addresses intercommunity drainage issues*
- *Project addresses erosion and sedimentation issues*

- *Project will address multiple Commission goals (e.g., water quality, runoff volume, aesthetics, wildlife habitat, recreation, etc.)*
- *Subwatershed draining to project includes more than one community*
- *Addresses significant infrastructure or property damage concerns*

The BCWMC will place a higher priority on projects that incorporate multiple benefits, and will seek opportunities to incorporate multiple benefits into BCWMC projects, as opportunities allow.

The Westwood Hills Nature Center Water Quality Project meets multiple of the gatekeeper criteria—the project is part of the BCWMC trunk system, the project would improve water quality, increase education opportunities, provide habitat, and address multiple commission goals.

2.2 Considerations

The following considerations played a key role in determining recommendations for the Westwood Hills Nature Center Water Quality Project and should continue to be evaluated through final design:

1. Maximizing the water quality benefit.
2. Minimizing permitting required to construct the project.
3. Minimizing wetland impacts.
4. Minimizing tree loss.
5. Adding educational opportunities.

3.0 Stakeholder Input

3.1 Public Stakeholder Meeting

Two public stakeholder open house meetings were held on February 22 and 28, 2018. The City of St. Louis Park and their consultant organized these meetings. The BCWMC administrator did not attend either meeting, however Chair de Lambert did attend one of the meetings. While the presentations and discussions focused on the proposed interpretive center, the BCWMC had a display at the meetings with a watershed map, a brief project description, educational materials, and information about the BCWMC. An opportunity was provided for residents to offer thoughts or concerns about the project on index cards; however, no comments were passed along to Barr or BCWMC concerning the water quality portion of the project.

3.2 Technical Stakeholder Meeting

Two technical stakeholder meetings were held for the project. The first was held onsite on November 21, 2017. The meeting included representatives from the City of St. Louis Park, HGA (the city's architect and engineer), and the Commission Engineer. The attendees discussed project scope, field work schedule, design and meeting schedules, and site layout.

The second meeting was held at City of St. Louis Park offices on March 1, 2018. Attendees included representatives from the City of St. Louis Park, the city's consultant, the BCWMC administrator, and the BCWMC Engineer. Attendees discussed possible design concepts, permitting needs, project schedule and funding were also reviewed.

3.3 BCWMC Stakeholder Comments

A draft version of the April 2018 draft report was provided to the BCWMC administrator and City of St. Louis Park staff. The draft feasibility study was revised in response to the comments received. Additional review of the technical comments is recommended during final design.

4.0 Water Quality Improvement Concepts

This section provides a summary of the alternatives analyzed for water quality and other improvements at WHNC. Multiple alternatives were evaluated for removing sediment, improving water quality, protecting and enhancing fish and wildlife habitat, and adding aesthetic and educational opportunities within the project area. The measures considered for potential implementation include the following:

- Adding additional permeable paver parking bays in the proposed parking lot for water quality treatment and a possible reduction of salt application in the parking bay (Concept 1)
- Increasing the size of proposed filtration basins, or supplementing the site with additional filtration basins (Concept 2)
- Installing a linear water quality feature on the north side of the interpretive center with signage and interactive features for education (Concept 3)
- Directing additional site runoff to Turtle Pond to increase the water quality treatment provided by the pond (Concept 3)
- Heating concrete sidewalks near building to avoid placing salt during winter months (Concept 4)
- Water reuse (Concept 5)

Five water quality treatment concepts were developed. The proposed concepts will reduce sediment, phosphorus, or chloride loading to Westwood Lake and all downstream water bodies, including Bassett Creek and the Mississippi River.

4.1 Concept 1 – Additional Permeable Pavers

Concept 1 includes installing additional permeable pavers in the proposed parking lot. The proposed parking lot is designed with an outer and inner ring of parking stalls and includes permeable pavers at the inner ring location. Concept 1 would increase the amount of pervious concrete pavers by constructing the outer ring of parking stalls with the same permeable paver design proposed for the inner ring of parking stalls. All pervious pavers would include granular filters with draintile beneath them. An overflow structure would be installed in each paver bay to minimize flooding if the pavers become plugged. Educational signage would be installed near the pavers explaining how the system works to improve

water quality and why chlorides are harmful to aquatic resources. Concept 1 is shown in detail on Figure 4-1.

The soil borings show soils near the proposed parking lot that would not be conducive to infiltration. As a result, the permeable pavers are designed as a filtration system. Pervious pavers improve water quality by trapping sediments and nutrients at the surface or in the sand filter below. There is also evidence that pervious pavers require less salt application during winter months than traditional bituminous or concrete paving. Installing additional permeable pavers would reduce sediment and nutrient loading, and may reduce chloride loading to Westwood Lake, Bassett Creek, and the Mississippi River. Signage could be used to educate the visitors on how the pavers are improving water quality in the watershed.

To maintain effectiveness, permeable pavers must be maintained. Regular maintenance includes removing accumulated sediment or organic matter with sweeping and cleaning out the drintile. Even with regular maintenance, eventually the pavers may need to be removed and reinstalled to replace the filter media. The life of the pavers depends on how well they are maintained.

4.2 Concept 2 – Expand Filtration Basins

Concept 2 includes increasing size and filtration capacity of the proposed filtration basins on the south side of the proposed interpretive center. Two areas have been identified for expansion of the filtration basins, which could provide an additional 3,300 cubic feet (0.08 acre-feet) of storage. Educational signage would be installed near the basins explaining how the system works to improve water quality and habitat. Concept 2 is shown in detail on Figure 4-2. At the time of this report, the site design for the WHNC reconstruction project had not yet been completed. It is possible additional locations could be identified for expansion of the filtration basins. This should be evaluated during final design.

The soil borings show soils near the proposed parking lot that would not be conducive to infiltration. As a result, the basins are designed as filtration systems. The expanded filtration basins would match the design of the proposed filtration basins. These designs have not yet been finalized but will generally include a sand trench with drintile, planting soil, surface mulch, plantings, and an overflow outlet. Filtration basins improve water quality by trapping sediments and nutrients, or removing nutrients through plant uptake. Expanding the proposed filtration basins would increase the filtration capacity of the basins, and further reduce the sediment and nutrient loading to Westwood Lake, Bassett Creek, and the Mississippi River. Signage could be used to educate the visitors on how the basins are improving water quality in the watershed.

To maintain effectiveness, filtration basins must be maintained. Regular maintenance includes removal of trash and debris, weeding, cleaning out the drintile, loosening the surface of the basin, removing accumulated sediment or organic material, replacing plants, and replacing surface mulch. Even with regular maintenance, eventually the filtration basins may require removal and replacement of the planting soil, plants, and sand trench to restore effectiveness.

Adding iron filings to the sand trenches for iron enhanced sand filtration to remove soluble phosphorus was discussed. Soil borings near the basins show groundwater elevations to be as high as 888.0 feet

(NAVD88 datum), and could be higher when groundwater is seasonally high. The basin sand trenches could be close to this elevation. We do not recommend using iron in continuously wet areas as the system can go anoxic, the iron can clump together, the system may discharge iron into the downstream waterbodies, and may not function as intended. Most of the maintenance for this option could be accomplished with volunteers.

4.3 Concept 3 – Linear Water Feature

Concept 3 includes collecting stormwater runoff from the roof of the proposed interpretive center and the north patio areas. Runoff would be routed through a series of meandering channels and basins on the north side of the proposed interpretive center. Pumps would recirculate the runoff through the channels and basins until it leaves the system through infiltration, evaporation, or evapotranspiration. The recirculation pumps could be solar-powered or manual. An overflow would be provided from the downstream basin to Turtle Pond for storm events larger than the design event. Turtle Pond is currently stagnant and receives minimal runoff. This concept would increase flows to Turtle Pond, which may improve its water quality.

All of the basins and channels would be constructed to promote infiltration. Soils may not be highly conducive to infiltration, however an appropriate infiltration rate for the soil type would be used in design calculations. Infiltration basins improve water quality by trapping sediments and nutrients, or removing nutrients through plant uptake, and reducing runoff volume. Routing stormwater runoff to this series of channels and basins would reduce the sediment and nutrient loading to Westwood Lake, Bassett Creek, and the Mississippi River.

To maintain effectiveness, infiltration basins must be maintained. Regular maintenance includes removal of trash and debris, weeding, cleaning out the drain tile, loosening the material at the surface of the basin, removing accumulated sediment or organic material, replacing plants, and replacing surface mulch. Even with regular maintenance, eventually the basins may require removal and replacement of surface mulch and plants.

In addition to water quality benefits, this system could be designed as an educational experience with signage, pedestrian bridges, and interactive features. A recirculation pump could be powered with a stationary bike, a wheel, or a hand crank. When initiated, the manual pumping could discharge at a highly visible, elevated, and accessible location. These, or similar educational features, would allow WHNC visitors to see the connection between their effort and the recirculation flow. A separate solar-powered recirculation pump could provide a lower “base-flow” for the system to ensure that the system is providing consistent water quality treatment. A manual switch could be provided for the pumps to turn them off during winter months or when visitors are not at the site.

WHNC had nearly 36,000 program participants in 2017, ranging in age from toddlers to seniors. There were also an unknown number of visitors who used the park and trails. WHNC staff develops educational programming for many groups throughout the year. Discussions with WHNC staff resulted in the following ideas for educational opportunities related to Concept 3:

- Install a rain gauge and record how much it rains. Relate the gauge to the amount of water in the system. Have discussion about precipitation trends and if the area is in a wet or dry cycle.
- Place a visual marker within the manhole which shows water level in the pipe/manholes. Relate the marker to the recent amount of rain, or lack of rain.
- Construct the structure that conveys rain from the roof down to the water feature in a location that can be seen when standing inside the building and out on the patio.
- Install signage showing the volume of runoff the system holds and the runoff volume the building roof is generating, which otherwise would be infiltrated if the area was forested.
- Install signage showing the complete hydrologic cycle from rain, runoff, infiltration, evapotranspiration, and overflow; install markers along the linear water feature system to identify each part in the cycle.
- Plant each basin with specific plants for wet and dry zones, allowing staff to educate visitors on plant identification.
- Measure the amount the solar pump is pumping and show how the amount of water being pumped increases when the sun is brighter.
- Install signage inside the building showing the different habitats that are present as part of the greater WHNC project. The linear water feature would give staff a way to show visitors some of those habitats.
- Collect water quality samples from the water feature pools and from Turtle pond, and compare the water quality in each, and to other samples from Westwood Lake.
- Discuss the importance of erosion control when viewing the controlled elevation drops through the linear water feature system.
- Note the variety of animals fairly close to the building as a result of the habitat provided by the linear water feature.

This concept would also provide added aesthetics to the north side of the building. Most of the maintenance for this option could be accomplished with volunteers. According to WHNC staff, they have a greater number of volunteers than they have activities for volunteers to help with.

4.4 Concept 4 – Heated Sidewalks

Concept 4 includes installing heated sidewalks between the building and the parking lot. The location of the heated sidewalks is shown on Figure 4-4. Two systems were briefly evaluated for this concept. Circulating glycol was not deemed a practical option for this location as pump and heater locations would be required throughout the sidewalk area and heating would be uneven. An electrical system would be more effective with this layout, however annual electric costs would be greater than if a glycol system was installed. If heated sidewalks are the chosen concept, we recommend an electrical system; the concept 4 cost estimate in Table 6-1 is based on an electrical system. This option would require annual maintenance by a building maintenance engineer. Educational signage would be installed near the sidewalks explaining how the system works to improve water quality and why chlorides are harmful to aquatic resources.

4.5 Concept 5 – Water Reuse

Concept 5 includes capturing stormwater runoff from the building roof and reusing the water for toilet flushing and possibly animal care. This option was considered by the WHNC design engineer/architect while designing the building, however was eliminated due to high costs. Water reuse inside the building would require treating the stormwater with filtration and disinfection prior to reuse, and permitting by the Minnesota Department of Health. If there are 36,000 visitors to the building annually, with an average of 1.5 gallons per flush, 1.5 flushes per person, the annual peak water demand would be 81,000 gallons. A 1.1-inch rainfall event would generate approximately 8,600 gallons of runoff from the 12,000 square foot building roof. Approximately nine 1.1-inch rainfall events would be required to meet the annual water demand. The total construction cost would depend on the amount of storage that is desired. The greater the amount of storage, the more demand could be met with reuse water rather than city water, but it is not feasible to install enough storage to meet the entire peak demand with reuse water. Daily number of visitors vary. Based on data from WHNC, we have assumed 200 average daily users for the water balance and storage calculation. The cost estimate for this report assumes 10,000 gallons of storage.

This option would require annual maintenance by a building maintenance engineer. Educational signage would be installed explaining how the system conserves water and improves water quality.

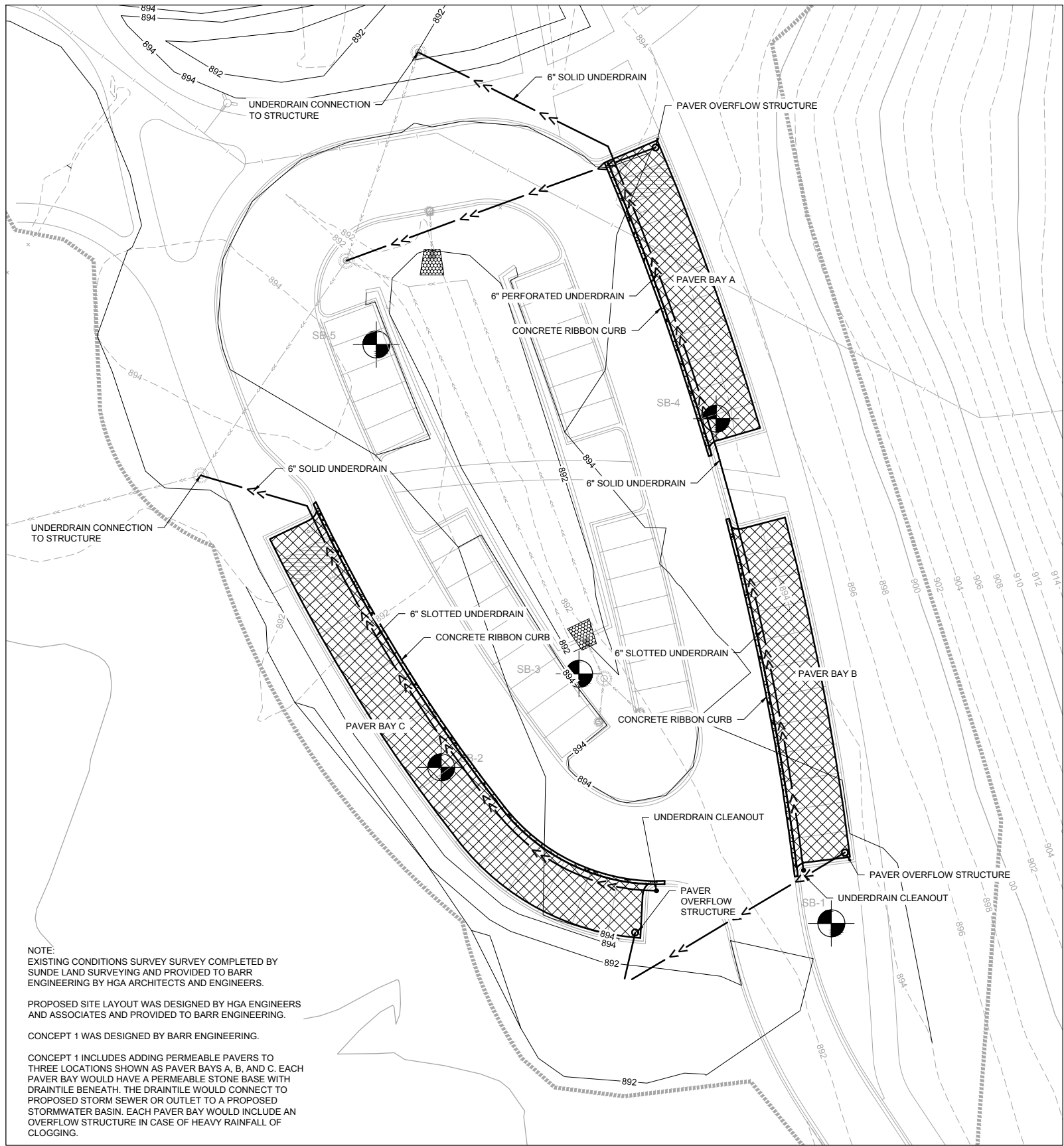

NOTE:
EXISTING CONDITIONS SURVEY SURVEY COMPLETED BY SUNDE LAND SURVEYING AND PROVIDED TO BARR ENGINEERING BY HGA ARCHITECTS AND ENGINEERS.

PROPOSED SITE LAYOUT WAS DESIGNED BY HGA ENGINEERS AND ASSOCIATES AND PROVIDED TO BARR ENGINEERING.

CONCEPT 1 WAS DESIGNED BY BARR ENGINEERING.

CONCEPT 1 INCLUDES ADDING PERMEABLE PAVERS TO THREE LOCATIONS SHOWN AS PAVER BAYS A, B, AND C. EACH PAVER BAY WOULD HAVE A PERMEABLE STONE BASE WITH DRAINTILE BENEATH. THE DRAINTILE WOULD CONNECT TO PROPOSED STORM SEWER OR OUTLET TO A PROPOSED STORMWATER BASIN. EACH PAVER BAY WOULD INCLUDE AN OVERFLOW STRUCTURE IN CASE OF HEAVY RAINFALL OF CLOGGING.

LEGEND:

| | |
|-------|--|
| —900— | EXISTING MAJOR CONTOUR |
| -899- | EXISTING MINOR CONTOUR |
| -900- | PROPOSED MAJOR CONTOUR |
| -899- | PROPOSED MINOR CONTOUR |
| -900- | BCWMC CIP MAJOR CONTOUR |
| -899- | BCWMC CIP MINOR CONTOUR |
| — | PROPOSED WATER LINE |
| ▽ | PROPOSED HYDRANT |
| →→ | PROPOSED STORM STORM |
| →→ | BCWMC CIP STORM SEWER |
| ○ | PROPOSED MANHOLE |
| ● | PROPOSED CATCH BASIN |
| ⊙ | SOIL BORING |
| ▨ | WST-2 STORMWATER TREATMENT (BY BARR ENGINEERING) |

CONCEPT LEVEL DRAFT COST ESTIMATES

- PAVER BAY A: \$37,000 TO \$60,000
- PAVER BAY B: \$38,000 TO \$62,000
- PAVER BAY C: \$52,000 TO \$84,000
- TOTAL ESTIMATE: \$127,000 TO \$206,000**

- ASSUMPTIONS:**
- SUBCUT AND COMMON EXCAVATION PROVIDED BY PROPOSED PROJECT AND NOT REQUIRED AS PART OF BCWMC CIP WORK.
 - PROPOSED STORM SEWER STRUCTURES ARE FABRICATED WITH KNOCKOUTS FOR BCWMC CIP STORM SEWER.
 - ESTIMATE INCLUDES DESIGN AND CONSTRUCTION COSTS

1 PLAN: WST-2 FEASIBILITY STUDY - CONCEPT 1: ADDITIONAL PERMEABLE PAVERS
AS SHOWN



ISSUED FOR REVIEW
NOT FOR CONSTRUCTION

CADD USER: Josh Phillips FILE: M:\DESIGN\23270051_40\23270051_40_CONCEPT_1_DWG_PLOT SCALE: 1:2 PLOT DATE: 4/11/2018 3:33 PM
BARR M:\AutoCAD 2011\AutoCAD 2011 Support\template\Barr_2011_Template.dwt Plot at 1: 10/05/2010 14:03:50

| | | | | | |
|-----|-----|-----|------|------------|-----------------------|
| NO. | BY | CHK | APP. | DATE | REVISION DESCRIPTION |
| B | JPP | MAK | KLC | 04/11/2018 | BCWMC AND CITY REVIEW |
| A | JPP | MAK | KLC | 03/09/2018 | BCWMC AND CITY REVIEW |

I HEREBY CERTIFY THAT THIS PLAN, SPECIFICATION, OR REPORT WAS PREPARED BY ME OR UNDER MY DIRECT SUPERVISION AND THAT I AM A DULY LICENSED PROFESSIONAL ENGINEER UNDER THE LAWS OF THE STATE OF MINNESOTA.

PRINTED NAME: _____
SIGNATURE: _____
DATE: _____ LICENSE # _____

| | | | | | | | | | |
|-----------------|----------|----------|---|---|---|---|---|--|--|
| CLIENT | 03/09/18 | 04/11/18 | | | | | | | |
| BID | | | | | | | | | |
| CONSTRUCTION | | | | | | | | | |
| RELEASED TO/FOR | A | B | C | 0 | 1 | 2 | 3 | | |
| DATE RELEASED | | | | | | | | | |

BARR Project Office:
BARR ENGINEERING CO.
4300 MARKETPOINTE DRIVE
Suite 200
MINNEAPOLIS, MN 55435

Corporate Headquarters:
Minneapolis, Minnesota
Ph: 1-800-632-2277
Fax: (952) 832-2601
www.barr.com

| | |
|----------|------------|
| Scale | AS SHOWN |
| Date | 04/11/2018 |
| Drawn | JPP |
| Checked | MAK |
| Designed | MAK |
| Approved | KLC |

BCWMC

WESTWOOD LAKE WATER QUALITY IMPROVEMENT PROJECT (WST-2)

FEASIBILITY STUDY - CONCEPT 1
ADDITIONAL PERMEABLE PAVERS

| | |
|--------------------|---------------|
| BARR PROJECT No. | 23/27-0051.40 |
| CLIENT PROJECT No. | |
| DWG. No. | FIGURE 4-1 |
| REV. No. | B |

CADD USER: Josh Phillips FILE: \\A:\DESIGN\23270051_4023270051_40_CONCEPT_2_DWG_PLOT SCALE: 1:2 PLOT DATE: 4/11/2018 3:33 PM
 BARR: \\A:\AutoCAD 2011\AutoCAD 2011\Support\enu\template\Barr_2011_Template.dwt Plot at 1: 10/05/2010 14:03:50

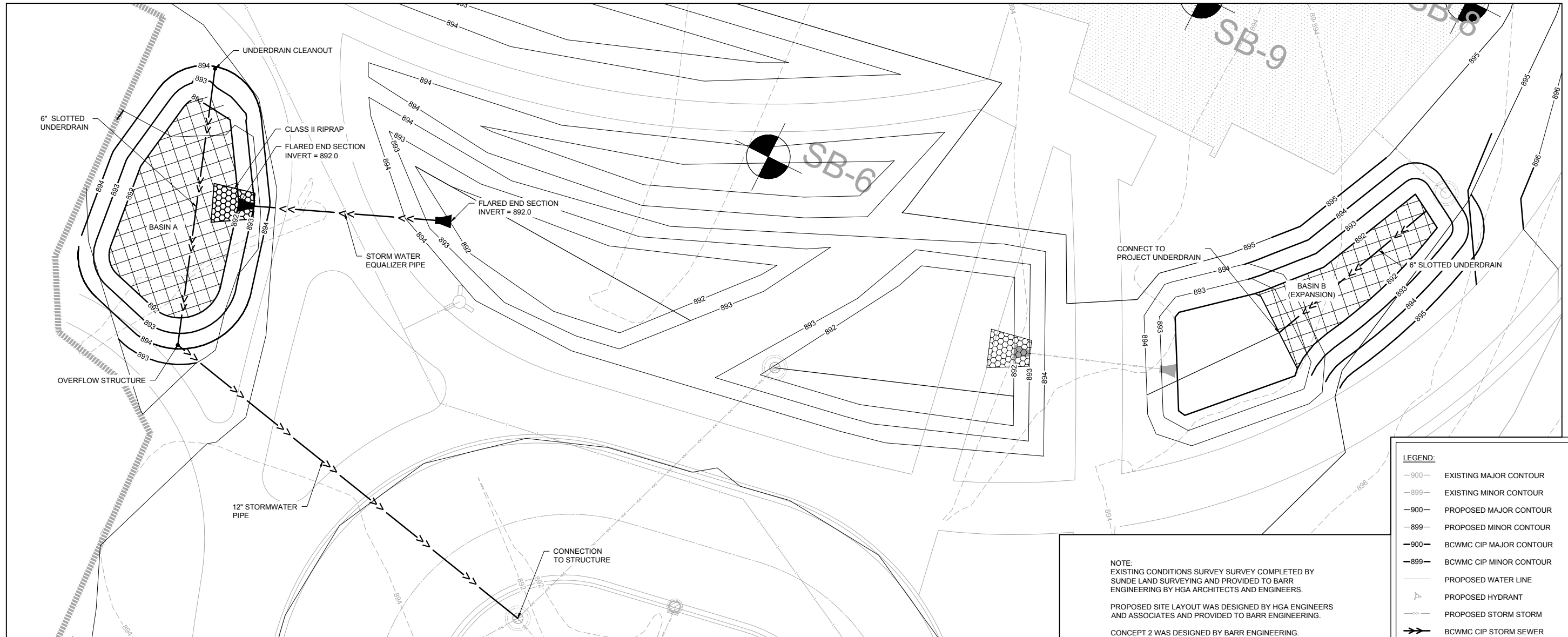

1 PLAN: WST-2 FEASIBILITY STUDY - CONCEPT 2: EXPANDED FILTRATION BASINS AS SHOWN



NOTE:
 EXISTING CONDITIONS SURVEY SURVEY COMPLETED BY SUNDE LAND SURVEYING AND PROVIDED TO BARR ENGINEERING BY HGA ARCHITECTS AND ENGINEERS.

PROPOSED SITE LAYOUT WAS DESIGNED BY HGA ENGINEERS AND ASSOCIATES AND PROVIDED TO BARR ENGINEERING.

CONCEPT 2 WAS DESIGNED BY BARR ENGINEERING.

CONCEPT 2 INCLUDES EXPANDING HGA'S PROPOSED STORMWATER BASIN IN TWO LOCATIONS. BASIN A EXPANDS THE BASIN TO A NEW AREA OF THE SITE, AND BASIN B EXPANDS EXISTING GRADING ON THE WEST SIDE OF THE BASIN. THE EXPANDED BASIN AREAS WOULD MATCH HGA'S PROPOSED STORMWATER BASINS TO INCLUDE A GRANULAR TRENCH WITH DRAINTILE. THE DRAINTILE WOULD TIE INTO HGA'S DESIGN OR THE PROPOSED STORM SEWER. THE EXPANDED BASIN AREAS WOULD MATCH THE ELEVATIONS HGA'S PROPOSED STORMWATER BASIN AND BASIN A WOULD BE CONNECTED WITH AN EQUALIZED PIPE. THE EXPANDED BASIN AREAS WOULD BE PLANTED TO MATCH THE PLANTINGS OF HGA'S PROPOSED STORMWATER BASIN.

LEGEND:

- 900- EXISTING MAJOR CONTOUR
- 899- EXISTING MINOR CONTOUR
- 900- PROPOSED MAJOR CONTOUR
- 899- PROPOSED MINOR CONTOUR
- 900- BCWMC CIP MAJOR CONTOUR
- 899- BCWMC CIP MINOR CONTOUR
- PROPOSED WATER LINE
- ▲ PROPOSED HYDRANT
- PROPOSED STORM STORM
- BCWMC CIP STORM SEWER
- PROPOSED MANHOLE
- PROPOSED CATCH BASIN
- ⊙ SOIL BORING
- ▣ WST-2 STORMWATER TREATMENT (BY BARR ENGINEERING)

CONCEPT LEVEL DRAFT COST ESTIMATE:
 • TOTAL ESTIMATE RANGE = \$47,000 TO \$76,000

- ASSUMPTIONS:**
- PROPOSED STORM SEWER STRUCTURES ARE FABRICATED WITH KNOCKOUTS FOR BCWMC CIP STORM SEWER
 - PLANTINGS SPACED 18" O.C. IN BASINS, INCLUDING BOTTOM AND SIDE SLOPES
 - ESTIMATE INCLUDES DESIGN AND CONSTRUCTION COSTS

ISSUED FOR REVIEW
 NOT FOR CONSTRUCTION

| NO. | BY | CHK | APP | DATE | REVISION DESCRIPTION |
|-----|-----|-----|-----|------------|-----------------------|
| B | JPP | MAK | KAL | 04/11/2018 | BCWMC AND CITY REVIEW |
| A | JPP | MAK | KAL | 03/09/2018 | BCWMC AND CITY REVIEW |

I HEREBY CERTIFY THAT THIS PLAN, SPECIFICATION, OR REPORT WAS PREPARED BY ME OR UNDER MY DIRECT SUPERVISION AND THAT I AM A DULY LICENSED PROFESSIONAL ENGINEER UNDER THE LAWS OF THE STATE OF MINNESOTA.

PRINTED NAME: _____
 SIGNATURE: _____
 DATE: _____ LICENSE # _____

| CLIENT | 03/09/18 | 04/11/18 | | | | | | | |
|-----------------|----------|----------|---|---|---|---|---|--|--|
| BID | | | | | | | | | |
| CONSTRUCTION | | | | | | | | | |
| RELEASED TO/FOR | A | B | C | 0 | 1 | 2 | 3 | | |
| DATE RELEASED | | | | | | | | | |

BARR Project Office:
 BARR ENGINEERING CO.
 4300 MARKETPOINTE DRIVE
 Suite 200
 MINNEAPOLIS, MN 55435

Corporate Headquarters:
 Minneapolis, Minnesota
 Ph: 1-800-632-2277
 Fax: (952) 832-2601
 www.barr.com

| | |
|----------|------------|
| Scale | AS SHOWN |
| Date | 04/11/2018 |
| Drawn | JPP |
| Checked | MAK |
| Designed | MAK |
| Approved | KLC |

BCWMC

WESTWOOD LAKE WATER QUALITY IMPROVEMENT PROJECT (WST-2)
 FEASIBILITY STUDY - CONCEPT 2
 EXPANDED FILTRATION BASINS

| | |
|--------------------|---------------|
| BARR PROJECT No. | 23/27-0051.40 |
| CLIENT PROJECT No. | |
| DWG. No. | FIGURE 4-2 |
| REV. No. | B |

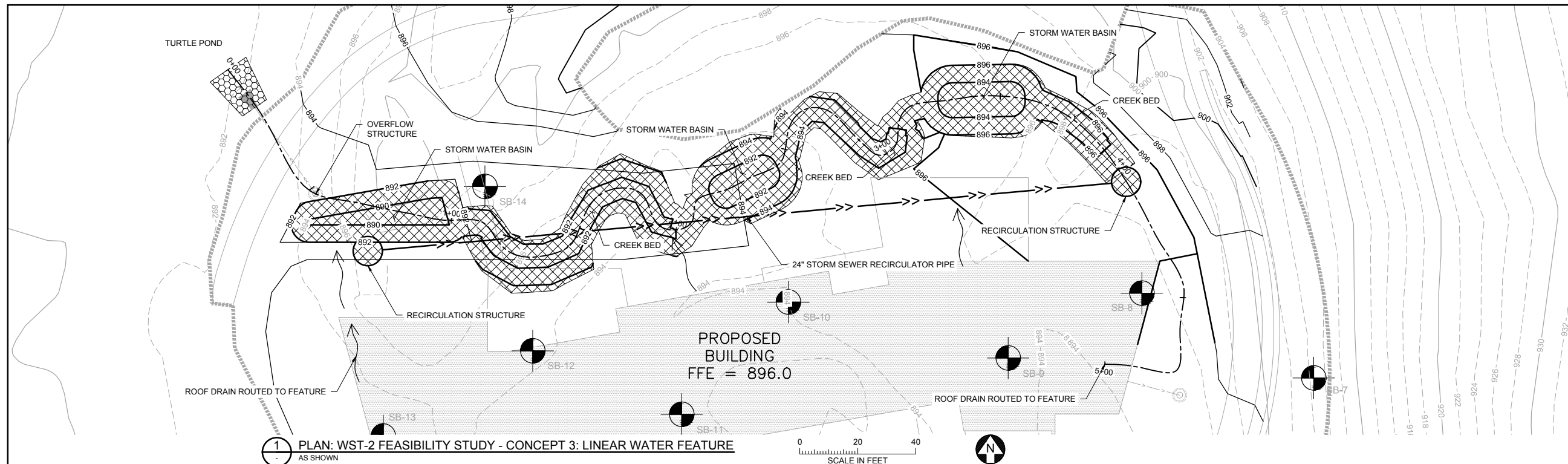

1 PLAN: WST-2 FEASIBILITY STUDY - CONCEPT 3: LINEAR WATER FEATURE AS SHOWN

0 20 40
SCALE IN FEET

LEGEND:

- 900— EXISTING MAJOR CONTOUR
- 899- EXISTING MINOR CONTOUR
- 900- PROPOSED MAJOR CONTOUR
- 899- PROPOSED MINOR CONTOUR
- 900- BCWMC CIP MAJOR CONTOUR
- 899- BCWMC CIP MINOR CONTOUR
- PROPOSED WATER LINE
- △ PROPOSED HYDRANT
- PROPOSED STORM STORM
- BCWMC CIP STORM SEWER
- PROPOSED MANHOLE
- PROPOSED CATCH BASIN
- ⊙ SOIL BORING
- ROOF AND PATIO RUNOFF ROUTED TO LINEAR STORMWATER FEATURE
- ▨ WST-2 STORMWATER TREATMENT (BY BARR ENGINEERING)

CONCEPT LEVEL DRAFT COST ESTIMATE:

- TOTAL ESTIMATE RANGE = \$255,000 TO \$414,000

ASSUMPTIONS:

- ESTIMATE DOES NOT INCLUDE STRUCTURES TO GET THE WATER FROM THE ROOF INTO THE RECIRCULATION STRUCTURE.
- ESTIMATE INCLUDES DESIGN AND CONSTRUCTION COSTS

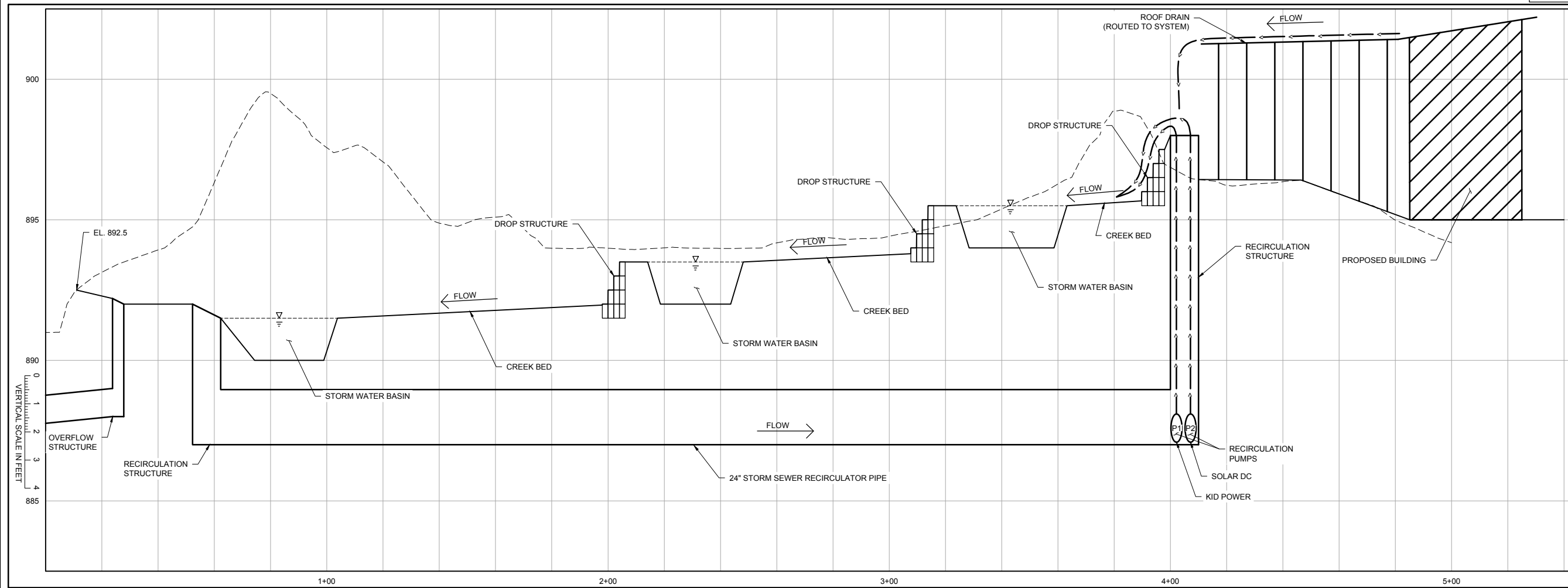

2 PROFILE: WST-2 FEASIBILITY STUDY - CONCEPT 3: LINEAR WATER FEATURE AS SHOWN

0 20 40
HORIZONTAL SCALE IN FEET

NOTE:
EXISTING CONDITIONS SURVEY SURVEY COMPLETED BY SUNDE LAND SURVEYING AND PROVIDED TO BARR ENGINEERING BY HGA ARCHITECTS AND ENGINEERS.
PROPOSED SITE LAYOUT WAS DESIGNED BY HGA ENGINEERS AND ASSOCIATES AND PROVIDED TO BARR ENGINEERING.
CONCEPT 2 WAS DESIGNED BY BARR ENGINEERING.
CONCEPT 2 INCLUDES CREATING A LINEAR WATER FEATURE ALONG THE NORTH SIDE OF THE BUILDING. ROOF AND PATIO RUNOFF WILL BE DIRECTED INTO A SERIES OF BASINS CONNECTED BY A MEANDERING CREEK.

ISSUED FOR REVIEW
NOT FOR CONSTRUCTION

CADD USER: Josh Phillips FILE: \\A:\DESIGN\23270051_402327005_40_CONCEPT_3_DWG_PLOT SCALE: 1:2 PLOT DATE: 4/11/2018 4:06 PM
BARR: \\A:\AECAD\2011\AECAD\2011\AECAD\2011_Template.dwt Plot at 1: 10/05/2010 14:03:50

| | | | | | |
|-----|-----|-----|-----|------------|-----------------------|
| NO. | BY | CHK | APP | DATE | REVISION DESCRIPTION |
| B | JPP | MAK | KAL | 04/11/2018 | BCWMC AND CITY REVIEW |
| A | JPP | MAK | KAL | 03/09/2018 | BCWMC AND CITY REVIEW |

I HEREBY CERTIFY THAT THIS PLAN, SPECIFICATION, OR REPORT WAS PREPARED BY ME OR UNDER MY DIRECT SUPERVISION AND THAT I AM A DULY LICENSED PROFESSIONAL ENGINEER UNDER THE LAWS OF THE STATE OF MINNESOTA.

PRINTED NAME: _____
SIGNATURE: _____
DATE: _____ LICENSE # _____

| | | | | | | | | | |
|-----------------|----------|----------|---|---|---|---|---|--|--|
| CLIENT | 03/09/18 | 04/11/18 | | | | | | | |
| BID | | | | | | | | | |
| CONSTRUCTION | | | | | | | | | |
| RELEASED TO/FOR | A | B | C | 0 | 1 | 2 | 3 | | |
| DATE RELEASED | | | | | | | | | |

BARR Project Office:
BARR ENGINEERING CO.
4300 MARKETPOINTE DRIVE
Suite 200
MINNEAPOLIS, MN 55435

Corporate Headquarters:
Minneapolis, Minnesota
Ph: 1-800-632-2277
Fax: (952) 832-2601
www.barr.com

| | |
|----------|------------|
| Scale | AS SHOWN |
| Date | 04/11/2018 |
| Drawn | JPP |
| Checked | MAK |
| Designed | KAL |
| Approved | KLC |

BCWMC

WESTWOOD LAKE WATER QUALITY IMPROVEMENT PROJECT (WST-2)

FEASIBILITY STUDY - CONCEPT 3
LINEAR WATER FEATURE

| | |
|--------------------|---------------|
| BARR PROJECT No. | 23/27-0051.40 |
| CLIENT PROJECT No. | |
| DWG. No. | FIGURE 4-3 |
| REV. No. | B |

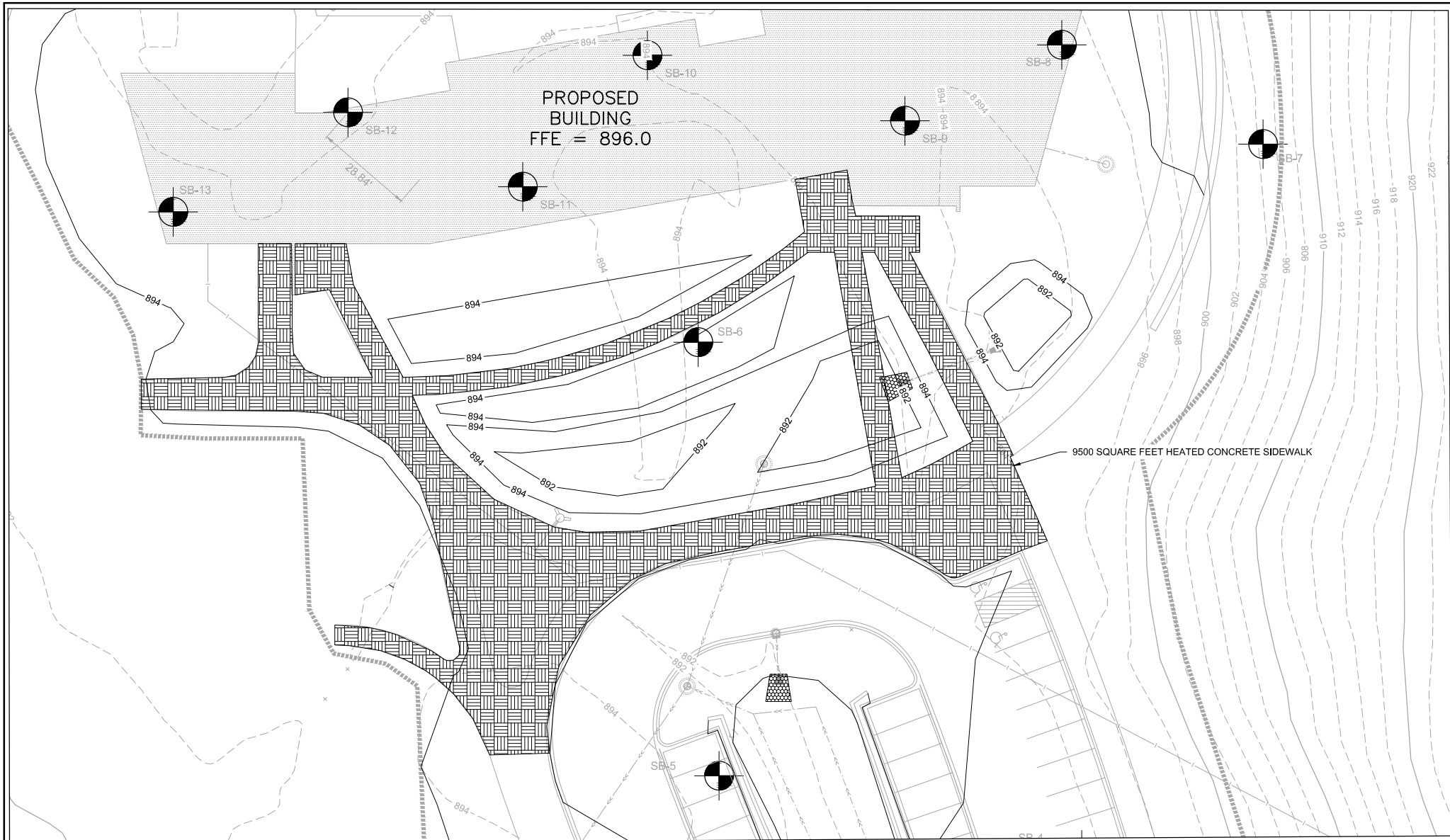

LEGEND:

- 900— EXISTING MAJOR CONTOUR
- 899- EXISTING MINOR CONTOUR
- 900- PROPOSED MAJOR CONTOUR
- 899- PROPOSED MINOR CONTOUR
- PROPOSED WATER LINE
- ⊙ PROPOSED HYDRANT
- PROPOSED STORM STORM
- PROPOSED MANHOLE
- ⊙ PROPOSED CATCH BASIN
- ⊙ SOIL BORING
- ▨ WST-2 HEATED CONCRETE SIDEWALK (BY BARR ENGINEERING)

ASSUMPTIONS:

- SUBCUT AND COMMON EXCAVATION PROVIDED BY PROPOSED PROJECT AND NOT REQUIRED AS PART OF BCWMC CIP WORK.

1 PLAN: WST-2 FEASIBILITY STUDY - CONCEPT 4: HEATED CONCRETE SIDEWALKS
AS SHOWN

0 20 40
SCALE IN FEET

NOTE:
EXISTING CONDITIONS SURVEY SURVEY COMPLETED BY SUNDE LAND SURVEYING AND PROVIDED TO BARR ENGINEERING BY HGA ARCHITECTS AND ENGINEERS.

PROPOSED SITE LAYOUT WAS DESIGNED BY HGA ENGINEERS AND ASSOCIATES AND PROVIDED TO BARR ENGINEERING.

CONCEPT 4 WAS DESIGNED BY BARR ENGINEERING.

CONCEPT 4 INCLUDES CREATING 9,500 SQUARE FEET OF HEATED CONCRETE SIDEWALK NEAR THE ENTRANCE TO THE PROPOSED INTERPRETIVE CENTER.

ISSUED FOR REVIEW
NOT FOR CONSTRUCTION

CADD USER: Josh Phillips FILE: M:\DESIGN\23270051_40\23270051_40_CONCEPT_1_DWG PLOT SCALE: 1:2 PLOT DATE: 5/8/2018 3:01 PM
BARR: M:\AutoCAD 2011\AutoCAD 2011 Support\enu\Template\Barr_2011_Template.dwt Plot at 1: 10/05/2010 14:03:30

| | | | | | | | | | | |
|---|--|-----------------|---------------|---|----------|------------|--|--|------------------|--|
| I HEREBY CERTIFY THAT THIS PLAN, SPECIFICATION, OR REPORT WAS PREPARED BY ME OR UNDER MY DIRECT SUPERVISION AND THAT I AM A DULY LICENSED PROFESSIONAL ENGINEER UNDER THE LAWS OF THE STATE OF MINNESOTA. | | CLIENT | 05/09/18 | Project Office: BARR ENGINEERING CO. 4300 MARKETPOINTE DRIVE Suite 200 MINNEAPOLIS, MN 55435 Corporate Headquarters: Minneapolis, Minnesota Ph: 1-800-632-2277 Fax: (952) 832-2601 www.barr.com | Scale | AS SHOWN | BCWMC | WESTWOOD LAKE WATER QUALITY IMPROVEMENT PROJECT (WST-2) | BARR PROJECT No. | |
| | | CONSTRUCTION | | | Date | 05/09/2018 | | | 23/27-0051.40 | |
| PRINTED NAME | | RELEASED TO/FOR | A B C 0 1 2 3 | DATE RELEASED | Drawn | MAK | FEASIBILITY STUDY - CONCEPT 4 HEATED CONCRETE SIDEWALKS | CLIENT PROJECT No. | | |
| SIGNATURE | | | | | Checked | JPP | | DWG. No. | | |
| DATE | | | | | Designed | MAK | | REV. No. | | |
| LICENSE # | | | | | Approved | KLC | | FIGURE 4-4 A | | |

5.0 Water Quality Impacts

This section discusses impacts of the Westwood Lake Water Quality Improvement Project, including estimated pollutant reductions resulting from each alternative. The MIDS Calculator was used to evaluate anticipated pollutant removals for Concept 1 and Concept 2. A water balance spreadsheet was used to evaluate anticipated pollutant removals for Concepts 3 and 5. Concept 4 will not remove TSS or TP loading. The same concentrations of TSS and TP loading was applied to both the MIDS Calculator evaluation and the water balance spreadsheet calculations. Table 5-1 summarizes the results from each alternative.

Table 5-1 Estimated Annual TSS and TP Removals for Concepts 1 – 5

| Alternative | Estimated TSS Removal (pounds/year) | Estimated TP Removal (pounds/year) |
|---|-------------------------------------|------------------------------------|
| Concept 1 – Additional Permeable Pavers | 39.5 | 0.171 |
| Concept 2 – Expand Filtration Basins | 0.7 | 0.004 |
| Concept 3 – Linear Water Feature | 59.9 | 0.330 |
| Concept 4 – Heated Sidewalk | 0 | 0 |
| Concept 5 – Water Reuse | 59.3 | 0.326 |

6.0 Project Cost Considerations

This section presents a feasibility level opinion of cost of the evaluated concepts, discusses potential funding sources, and provides an approximate project schedule.

6.1 Opinion of cost

The opinion of cost is a Class 4 feasibility-level cost estimate as defined by the American Association of Cost Engineers International (AACI International) and uses the assumptions listed below and detailed in the following sections.

1. The cost estimate assumes a 30% construction contingency.
2. Costs associated with design, permitting, and construction observation (collectively “engineering”) is assumed to be 30% of the estimated construction costs (excluding contingency).
3. Additional work may be required to determine if cultural and/or historical resources are present at any project site.

The Class 4 level cost estimates have an acceptable range of between -15% to -30% on the low range and +20% to +50% on the high range. Based on the development of concepts and initial vetting of the

concepts by the City of St. Louis Park, it is not necessary to utilize the full range of the acceptable range for the cost estimate; and we assume the final costs of construction may be between -20% and +30% of the estimated construction budget. The assumed contingency for the project (30%) incorporates the potential high end of the cost estimate range.

The estimated capital and a range of 20-year to 35-year annualized costs for each alternative are summarized in Table 6-1. Detailed cost-estimate tables for all concepts considered are provided in Appendix C.

6.2 Concept 3 Potential Cost Reduction

Based on comments received at the April 19, 2018 Commission meeting, we further analyzed concept 3 for possible cost reductions from the cost estimate shown in Appendix C. There are three basins shown in the linear water feature concept. The number of basins could be reduced to two, or the basins could be reduced in size for some cost savings. This will reduce line item D in the cost estimate, which is currently \$90,000. Cost savings could be up to \$10,000 with a basin area reduction. The remaining line items are necessary for the function of the concept and no other cost savings options were identified. Table 6-1 shows the concept 3 cost estimate without the potential cost reduction. With the cost reduction, the total cost would reduce from \$351,000 to \$334,000.

6.3 Funding Sources

This project is slated to receive funding through the BCWMC's Capital Improvement Program. The source of these funds is an ad valorem tax levied by Hennepin County over the entire Bassett Creek watershed on behalf of the BCWMC.

6.4 Project Schedule

For project construction to occur in 2019, project design would be completed 2018. The BCWMC is scheduled to hold a public hearing, order the project, certify levy costs to Hennepin County, and enter into an agreement with the City of St. Louis Park at its meeting on September 20, 2018. The City of St. Louis Park is currently preparing the final design.

Table 6-1 Estimated Capital and Annualized Costs for Concepts 1 – 5

| Alternative | Construction Cost | Construction Contingency ¹ | Planning, Engineering, Design, and Construction Observation ² | Total Cost | Estimated TSS Removal (lbs/year) | Estimated Annualized Cost per Pound of TSS Removal (\$/lb TSS/year) ³ | Estimated TP Removal (lbs/year) | Estimated Annualized Cost per Pound of TP Removal (\$/lb TP/year) ³ |
|---|-------------------|---------------------------------------|--|------------|----------------------------------|--|---------------------------------|--|
| Concept 1 – Additional Permeable Pavers | \$101,000 | \$30,000 | \$39,000 | \$170,000 | 39.5 | \$260 - \$340 | 0.171 | \$59,060 - \$78,950 |
| Concept 2 – Expand Filtration Basins | \$37,000 | \$11,000 | \$14,000 | \$62,000 | 0.7 | \$5,290 - \$7,140 | 0.004 | \$925,000 - \$1,250,000 |
| Concepts 1 plus Concept 2 | \$138,000 | \$41,000 | \$53,000 | \$232,000 | 40.2 | \$440 - \$580 | 0.175 | \$100,570 - \$133,710 |
| Concept 3 – Linear Water Feature | \$208,000 | \$62,000 | \$81,000 | \$351,000 | 59.9 | \$350 - \$470 | 0.330 | \$63,380 - \$84,610 |
| Concept 4 – Heated Sidewalk | \$151,000 | \$45,000 | \$59,000 | \$255,000 | 0 | n/a | 0 | n/a |
| Concept 5 – Water Reuse | \$174,000 | \$52,000 | \$68,000 | \$294,000 | 59.3 | \$300 - \$390 | 0.326 | \$53,680 - \$71,470 |

(1) Assumed 30% contingency based on feasibility-level design (Class 4, 10-15% design completion per ASTM E 2516-06).

(2) Assumed 30% of construction cost for Engineering, Design, and Construction Observation.

(3) Assumed 4% interest rate and 20-year to 35-year lifespan.

7.0 Permitting, Site Impacts, and Coordination

This section discusses permitting and coordination required for each alternative.

7.1 Permitting

No disturbance or fill of any wetlands, nor any work in public waters is anticipated as part of the WHNC reconstruction project. The City of St. Louis Park and its contractors will be responsible for any permits required by the WHNC reconstruction project. No additional permits are anticipated as part of the Westwood Lake Water Quality Improvement Project.

7.2 Site Impacts

Some tree removals are anticipated as part of the WHNC reconstruction project. Minimal additional tree removals and no additional site impacts are anticipated for the Westwood Lake Water Quality Improvement Project.

7.3 Coordination

Trail usage and pedestrian safety during construction is a significant consideration for the WHNC reconstruction project. The interpretive center and some nearby paths and trails will be closed during construction, but most WHNC paths and trails will remain open. Trail closure signs and barricades will be installed and a pedestrian detour route will be determined during final construction. The parking lot will also be closed during construction and the existing park entrance drive will be used for construction access. Minimal additional path and trail closures are anticipated as part of the Westwood Lake Water Quality Improvement Project. Continued coordination with the City of St. Louis Park's Parks and Recreation Department will be required during final design.

8.0 Recommendations

The Commission Engineer recommends Concept 3 – Linear Water Feature due to water quality improvement, education, cost effectiveness, and aesthetic possibilities. We recommend that the opinions of cost identified in this study be used to develop a levy request for the selected concept(s) and that the concept(s) proceeds to the design and construction phase.

9.0 References

1. **Bassett Creek Watershed Management Commission.** 2015 Watershed Management Plan. September 2015.

-
2. **Bassett Creek Watershed Management Commission.** 2015 Lake Water Quality Study, Westwood Lake, January 2016.

Appendix A

Westwood Hills Nature Center Site Topographic and Tree Survey

DESCRIPTION OF PROPERTY SURVEYED

Part of Outlet 1, Westwood Estates 2nd Addition, and part of Lot 1, Block 1, Westwood Estates, according to the recorded plats thereof, and part of the Southeast Quarter of Section 6, Township 117, Range 21, Hennepin County, Minnesota.

TITLE COMMITMENT

This survey was prepared without the benefit of current title work. Easements, appurtenances, and encumbrances may exist in addition to those shown hereon. This survey is subject to revision upon receipt of a current title insurance commitment or attorney's title opinion.

GENERAL NOTES

- 1.) Survey coordinate and bearing basis: Hennepin County Coordinates
2.) Wetlands shown hereon are per delineation markers observed in the process of conducting the fieldwork.
3.) Property is subject to Resolution Granting Conditional Use Permit per Document No. A10408790.

UTILITY NOTES

- 1.) Utility information from plans and markings was combined with observed evidence of utilities to develop a view of the underground utilities shown hereon. However, lacking excavation, the location of underground features cannot be accurately, completely and reliably depicted. Where additional or more detailed information is required, excavation and/or a private utility locate request may be necessary.
2.) Other underground utilities of which we are unaware may exist. Verify all utilities critical to construction or design.
3.) Contact GOPHER STATE ONE CALL at 651-454-0002 (800-252-1166) for precise onsite location of utilities prior to any excavation.

LEGEND

Table listing symbols and their meanings for various features like AIS (advertising sign), BE (building entrance), BR (bike rack), BRIG (bridge), BTL (beavertail curb), etc.

I hereby certify that this survey, plan, or report was prepared by me or under my direct supervision and that I am a duly Licensed Land Surveyor under the laws of the State of Minnesota.

Dated this 6th day of December, 2017

SUNDE LAND SURVEYING, LLC.

By: Arlee J. Carlson, P.L.S. Minn. Lic. No. 44900

Project information box including drawing title 'PARTIAL BOUNDARY, LOCATION, TOPOGRAPHIC and UTILITY SURVEY FOR City of St. Louis Park Westwood Hills Nature Center', Sunde Land Surveying logo, and project details like Project: 2017-204, Date: 12/06/2017.

BENCH MARKS (BM)

(NGVD 29)

- 1.) Top of top nut of fire hydrant southeast of school building. Elevation = 912.77 feet
2.) Top of concrete base on south side of light pole in center island of parking lot. Elevation = 895.21 feet
3.) Top of top nut of fire hydrant on west side of Westwood Hills Drive opposite #1649. Elevation = 944.21 feet

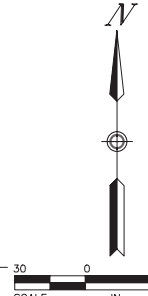

LEGEND

- AIS Denotes advertising/information sign
- BE Denotes building entrance
- BR Denotes bike rack
- BRIG Denotes bridge
- BTL Denotes beavertail curb
- CB Denotes catch basin
- CBOX Denotes control box
- CBX Denotes communication box
- CC Denotes curb cut
- CDS Denotes civil defense siren
- CP Denotes cast iron pipe
- COL Denotes building column
- CONC Denotes concrete
- CS Denotes curb stop
- DIP Denotes ductile iron pipe
- EB Denotes electric box
- EM Denotes electric meter
- EO Denotes electric outlet
- G Denotes gutter
- GDGR Denotes gate card reader
- GM Denotes gas meter
- GRDL Denotes ground light
- GW Denotes guy wire
- HCR Denotes disabled ramp
- HCS Denotes disabled sign
- HH Denotes hand hole
- HHC Denotes communication hand hole
- HFH Denotes fiber optic hand hole
- HYD Denotes fire hydrant
- INV Denotes structure invert
- KWB Denotes keystone wall base
- LP Denotes light pole
- MB Denotes mail box
- MG Denotes metal grate
- MOWELL Denotes monitoring well
- OD Denotes overhead door
- OHE Denotes overhead electric line
- (P) Denotes per plan
- PEP Denotes polyethylene pipe
- PKS Denotes parking sign
- PP Denotes power pole
- PPLP Denotes power and light pole
- PPT Denotes power pole with transformer
- PPU Denotes power pole with underground utility
- PTBL Denotes picnic table
- PVC Denotes polyvinylchloride pipe
- RCP Denotes reinforced concrete pipe
- RD Denotes roof drain
- SAN Denotes sanitary manhole
- SAN S Denotes sanitary sewer
- SANC Denotes sanitary cleanout
- SMH Denotes storm manhole
- SPG Denotes spigot
- ST S Denotes storm sewer
- STA Denotes survey control station
- SWB Denotes stone wall base
- TC Denotes top of concrete curb
- TCS Denotes traffic control sign
- TRANS Denotes transformer
- UGC Denotes underground communication line
- UGE Denotes underground electric line
- VSP Denotes vitrified sewer pipe
- W Denotes water line
- WAF Denotes drinking fountain
- WET Denotes wetland stake
- WST Denotes wood step
- WV Denotes water valve
- WVB Denotes wood wall base
- BAS Denotes Basswood tree
- BIR Denotes Birch tree
- BOX Denotes Boxelder tree
- CED Denotes Cedar tree
- COT Denotes Cottonwood tree
- CRAB Denotes Crabapple tree
- HACK Denotes Hackberry tree
- LOC Denotes Locust tree
- MPL Denotes Maple tree
- PIN Denotes Pine tree
- PINW Denotes White Pine tree
- POP Denotes Poplar tree
- SPCG Denotes Colorado Green Spruce tree
- SPR Denotes Spruce tree
- TR Denotes deciduous tree

| POINT NUMBER | NORTHING | EASTING | ELEVATION | DESCRIPTION |
|--------------|------------|------------|-----------|-------------|
| 3000 | 163529.824 | 499078.518 | 892.77 | Station |
| 3001 | 163555.536 | 498866.582 | 892.27 | Station |
| 3002 | 163744.161 | 499050.540 | 894.77 | Station |
| 3003 | 163914.572 | 499020.703 | 904.69 | Station |
| 3004 | 163796.481 | 498890.185 | 898.46 | Station |
| 3005 | 163767.445 | 498807.239 | 892.00 | Station |
| 3006 | 164078.060 | 499045.915 | 913.80 | Station |
| 3007 | 164143.534 | 499166.098 | 931.64 | Station |
| 3008 | 164271.359 | 499087.352 | 916.35 | Station |
| 3009 | 163317.503 | 499203.883 | 894.61 | Station |



Dated this 6th day of December, 2017
 Certified by: *Arlene J. Carlson*
 Arlene J. Carlson, P.L.S. Minn. Lic. No. 44900

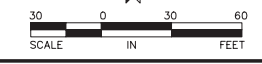

SUNDE LAND SURVEYING
 9001 East Bloomington Freeway (35W) • Suite 118
 Bloomington, Minnesota 55420-3435
 952-881-2455 Fax: 952-888-9589
 www.sunde.com
 File: 2017204001.dwg Sheet: 2 of 2



Appendix B

Soil Borings

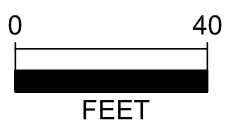
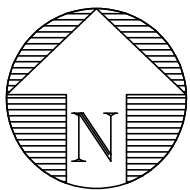
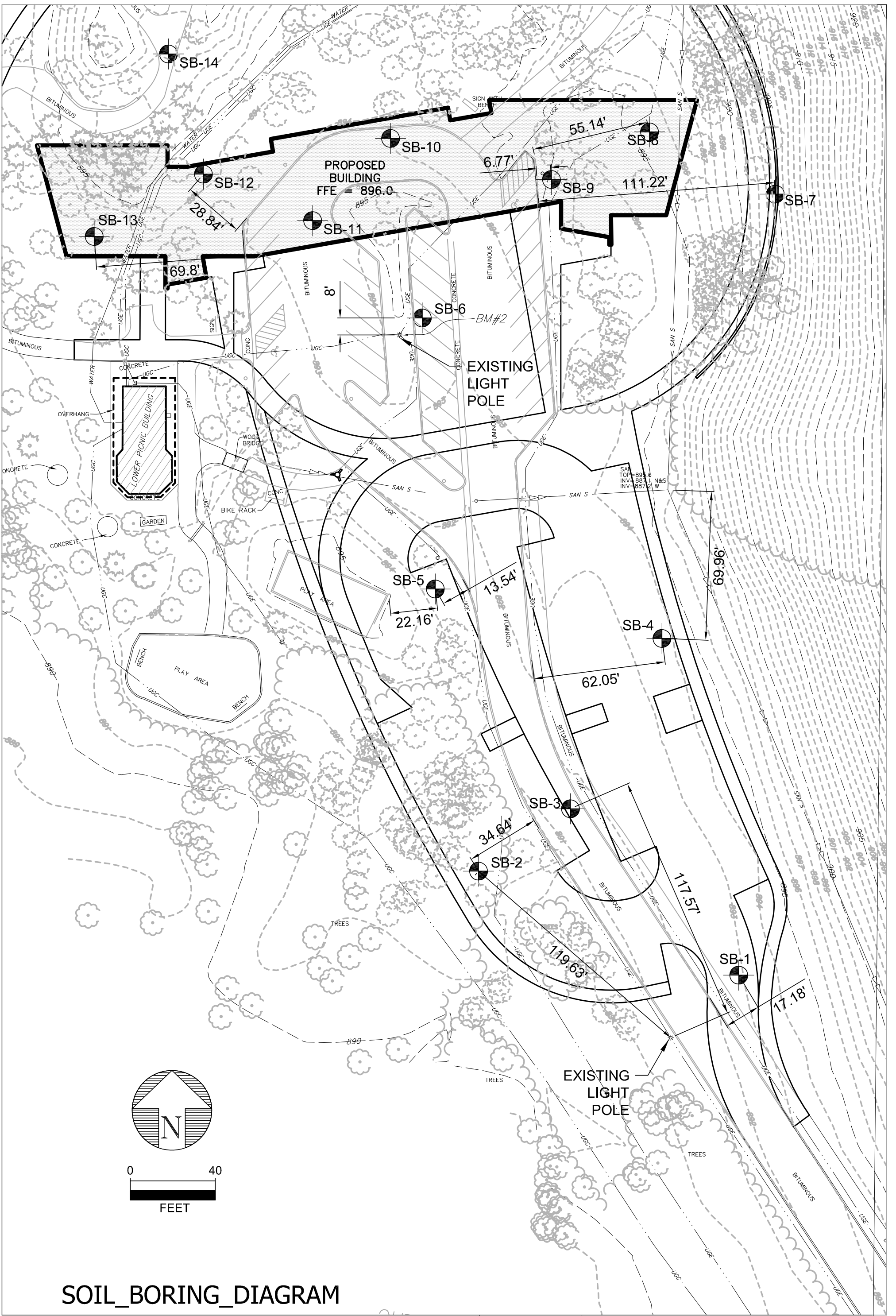

SOIL_BORING_DIAGRAM



Architecture | Engineering | Planning
 HAMMEL, GREEN AND ABRAHAMSON, INC.
 420 5th Street North - Suite 100
 Minneapolis, Minnesota 55401
 Telephone 612.758.4000 Facsimile 612.758.4199

| | |
|-----------|-------------|
| COMM. NO. | 1575-005-00 |
| SCALE | 1"=40' |
| DATE | 12/18/2017 |
| DRAWN | EH/DKS |

**WESTWOOD HILLS
 NATURE CENTER**
 8300 W FRANKLIN AVENUE
 ST. LOUIS PARK, MN 55426



SUBSURFACE BORING LOG

AET No: 01-07434 Log of Boring No. B-1 (p. 1 of 1)
 Project: Westwood Hills Nature Center; St. Louis Park, MN

| DEPTH IN FEET | Surface Elevation <u>893.4</u> MATERIAL DESCRIPTION | GEOLOGY | N | MC | SAMPLE TYPE | REC IN. | FIELD & LABORATORY TESTS | | | | |
|----------------------|--|----------------|---|----|-------------|---------|--------------------------|-----|----|----|--------|
| | | | | | | | WC | DEN | LL | PL | %-#200 |
| 1 | FILL, mostly clayey sand, a little gravel, trace roots, dark brown, frozen to 2' | FILL | | F | SU | | | | | | |
| 2 | | | | | | | | | | | |
| 3 | | | 8 | M | SS | 16 | | | | | |
| 4 | | | | | | | | | | | |
| 5 | SAPRIC PEAT, black, laminations of sand (PT) | SWAMP DEPOSIT | | M | SS | 18 | | | | | |
| 6 | | | | | | | | | | | |
| 7 | | | | | | | | | | | |
| 8 | CLAYEY SAND, trace roots, dark gray, moist, soft, laminations of sand (SC) | MIXED ALLUVIUM | | M | SS | 22 | | | | | |
| 9 | | | | | | | | | | | |
| 10 | | | 4 | W | SS | 18 | | | | | |
| 11 | | | | | | | | | | | |
| 12 | | | | | | | | | | | |
| 13 | SILT, trace roots, gray, wet, loose, laminations of sand (ML) | FINE ALLUVIUM | | W | SS | 20 | 30 | | | | |
| 14 | | | | | | | | | | | |
| 15 | SILTY SAND, fine to medium grained, gray, wet, loose (SM) | | | W | SS | 16 | | | | | |
| 16 | | | | | | | | | | | |
| END OF BORING | | | | | | | | | | | |

| DEPTH: | DRILLING METHOD | WATER LEVEL MEASUREMENTS | | | | | | | NOTE: REFER TO THE ATTACHED SHEETS FOR AN EXPLANATION OF TERMINOLOGY ON THIS LOG |
|---|------------------|--------------------------|-------|---------------|--------------|---------------|----------------------|-------------|--|
| 0-14½' | 3.25" HSA | DATE | TIME | SAMPLED DEPTH | CASING DEPTH | CAVE-IN DEPTH | DRILLING FLUID LEVEL | WATER LEVEL | |
| | | 1/26/18 | 10:30 | 11.5 | 9.5 | 9.6 | | 9.5 | |
| | | 1/26/18 | 10:35 | 11.5 | 9.5 | 9.6 | | 9.3 | |
| BORING COMPLETED: 1/26/18 | | | | | | | | | |
| DR: TA LG: SB Rig: 69C | | | | | | | | | |

AET_CORP 01-07434.GPJ AET+CPT+WELL.GDT 2/9/18



SUBSURFACE BORING LOG

AET No: 01-07434 Log of Boring No. B-2A (p. 1 of 1)
 Project: Westwood Hills Nature Center; St. Louis Park, MN

| DEPTH IN FEET | Surface Elevation <u>891.4</u> MATERIAL DESCRIPTION | GEOLOGY | N | MC | SAMPLE TYPE | REC IN. | FIELD & LABORATORY TESTS | | | | | | |
|---------------|--|-----------------|---|----|-------------|---------|--------------------------|-----|----|----|--------|--|--|
| | | | | | | | WC | DEN | LL | PL | %-#200 | | |
| 1 | FILL, mostly clayey sand, a little gravel, dark brown, frozen to 2' | FILL | | F | SU | | | | | | | | |
| 2-4 | FILL, mixture of silty sand and sandy lean clay, a little gravel, trace roots, brown and black | | 8 | M | SS | 20 | | | | | | | |
| 5-7 | HEMIC PEAT, dark brown (PT) | SWAMP DEPOSIT | 7 | M | SS | 16 | | | | | | | |
| 8-10 | SAPRIC PEAT, with shells, dark brown to light brown (PT) | | 2 | M | SS | 24 | | | | | | | |
| 11-12 | BOGLIME, trace shells and roots, white (OH-OL) | | 1 | M | SS | 24 | | | | | | | |
| 13-14 | SILTY SAND WITH GRAVEL, fine to medium grained, gray, wet, loose (SM) | COARSE ALLUVIUM | 7 | W | SS | 16 | | | | | | | |
| | END OF BORING | | | | | | | | | | | | |

| DEPTH: | DRILLING METHOD | WATER LEVEL MEASUREMENTS | | | | | | | NOTE: REFER TO THE ATTACHED SHEETS FOR AN EXPLANATION OF TERMINOLOGY ON THIS LOG |
|---|------------------|--------------------------|-------------|---------------|--------------|---------------|----------------------|-------------|--|
| | | DATE | TIME | SAMPLED DEPTH | CASING DEPTH | CAVE-IN DEPTH | DRILLING FLUID LEVEL | WATER LEVEL | |
| 0-12½' | 3.25" HSA | 1/26/18 | 9:20 | 14.5 | 12.5 | 12.5 | | 12.0 | |
| | | 1/26/18 | 9:25 | 14.5 | 12.5 | 12.5 | | 11.6 | |
| BORING COMPLETED: 1/26/18 | | | | | | | | | |
| DR: TA LG: SB Rig: 69C | | | | | | | | | |

AET_CORP 01-07434.GPJ AET+CPT+WELL.GDT 2/9/18



SUBSURFACE BORING LOG

AET No: 01-07434 Log of Boring No. B-3A (p. 1 of 1)
 Project: Westwood Hills Nature Center; St. Louis Park, MN

| DEPTH IN FEET | Surface Elevation <u>890.7</u> MATERIAL DESCRIPTION | GEOLOGY | N | MC | SAMPLE TYPE | REC IN. | FIELD & LABORATORY TESTS | | | | | | | |
|---------------------|--|-----------------|----|----|----------------|------------|--------------------------|-----|----|----|--------|--|--|--|
| | | | | | | | WC | DEN | LL | PL | %-#200 | | | |
| 1 | FILL, mostly clayey sand with organic fines, a little graavel, trace roots, dark brown, frozen to 2' | FILL | | | F | SU | | | | | | | | |
| 2 | FILL, mixture of clayey sand and silty sand, a little gravel, light brown and dark brown | | | | | | | | | | | | | |
| 3 | | | 9 | | M | SS | 18 | | | | | | | |
| 4 | | | | | | | | | | | | | | |
| 5 | HEMIC PEAT, black (PT) | SWAMP DEPOSIT | | | | | | | | | | | | |
| 6 | | | 7 | | | | | | | | | | | |
| 7 | HEMIC PEAT, with shells, black (PT) | | | | | | | | | | | | | |
| 8 | | | WH | | W | SS | 20 | | | | | | | |
| 9 | | | | | | | | | | | | | | |
| 10 | BOGLIME WITH SILT, trace shells, white and gray, wet (OH) | | WH | | W | SS | 24 | | | | | | | |
| 11 | | | | | | | | | | | | | | |
| 12 | | | WH | | W | SS | 24 | | | | | | | |
| 13 | | | | | | | | | | | | | | |
| 14 | | | WH | | W | SS | 24 | | | | | | | |
| 15 | | | | | | | | | | | | | | |
| 16 | SILT, a little gravel, trace roots, gray, wet, very loose, laminations of silty sand (ML) | MIXED ALLUVIUM | 2 | | W | SS | 20 | 35 | | | | | | |
| 17 | LEAN CLAY, gray, soft (CL) | FINE ALLUVIUM | | | | | | | | | | | | |
| 18 | CLAYEY SAND, a little gravel, gray, soft (SC) | MIXED ALLUVIUM | 3 | | W | SS | 20 | 34 | | | | | | |
| 19 | | | | | | | | 17 | | | | | | |
| 20 | SAND, fine to medium grained, gray, waterbearing, very loose to loose (SP) | COARSE ALLUVIUM | WH | | W | SS | 2 | | | | | | | |
| 21 | | | | | | | | | | | | | | |
| 22 | | | | | | | | | | | | | | |
| 23 | | | 7 | | W | SS | 20 | | | | | | | |
| 24 | END OF BORING | | | | | | | | | | | | | |

AET_CORP 01-07434.GPJ AET+CPT+WELL.GDT 2/9/18

| DEPTH: DRILLING METHOD | | WATER LEVEL MEASUREMENTS | | | | | | | NOTE: REFER TO THE ATTACHED SHEETS FOR AN EXPLANATION OF TERMINOLOGY ON THIS LOG |
|---------------------------|-----------------|--------------------------|------|---------------|--------------|---------------|----------------------|-------------|--|
| DEPTH | DRILLING METHOD | DATE | TIME | SAMPLED DEPTH | CASING DEPTH | CAVE-IN DEPTH | DRILLING FLUID LEVEL | WATER LEVEL | |
| 0-22½' | 3.25" HSA | 1/26/18 | 9:50 | 9.0 | 7.0 | 7.0 | | 6.5 | |
| | | 1/26/18 | 9:55 | 9.0 | 7.0 | 7.0 | | 6.0 | |
| BORING COMPLETED: 1/26/18 | | | | | | | | | |
| DR: TA LG: SB Rig: 69C | | | | | | | | | |



SUBSURFACE BORING LOG

AET No: 01-07434 Log of Boring No. B-4 (p. 1 of 1)
 Project: Westwood Hills Nature Center; St. Louis Park, MN

| DEPTH IN FEET | Surface Elevation <u>893.7</u> MATERIAL DESCRIPTION | GEOLOGY | N | MC | SAMPLE TYPE | REC IN. | FIELD & LABORATORY TESTS | | | | | | | |
|----------------------|--|---------------|----|-----|-------------|---------|--------------------------|-----|----|----|--------|--|--|--|
| | | | | | | | WC | DEN | LL | PL | %-#200 | | | |
| 1 | FILL, mostly clayey sand, trace roots, black and brown, frozen | FILL | | F | SU | | | | | | | | | |
| 2 | FILL, mostly silty sand, a little gravel, black, frozen to 3.5' | | 25 | F/M | SS | 20 | | | | | | | | |
| 3 | | | | | | | | | | | | | | |
| 4 | | | | | | | | | | | | | | |
| 5 | SAPRIC PEAT, black (PT) | SWAMP DEPOSIT | 5 | M | SS | 20 | | | | | | | | |
| 6 | | | | | | | | | | | | | | |
| 7 | ORGANIC CLAY, trace roots, black and gray, soft (CL) | | 4 | M | SS | 24 | 30 | | | | | | | |
| 8 | | | | | | | | | | | | | | |
| 9 | | | | | | | | | | | | | | |
| 10 | LEAN CLAY, gray, very soft (CL) | | 1 | W | SS | 18 | 28 | | | | | | | |
| 11 | | | | | | | | | | | | | | |
| 12 | SANDY LEAN CLAY, a little gravel, trace roots, gray, firm, lenses of sand (CL) | TILL | 6 | W | SS | 12 | 18 | | | | | | | |
| 13 | | | | | | | | | | | | | | |
| 14 | | | | | | | | | | | | | | |
| END OF BORING | | | | | | | | | | | | | | |

| DEPTH: | DRILLING METHOD | WATER LEVEL MEASUREMENTS | | | | | | | NOTE: REFER TO THE ATTACHED SHEETS FOR AN EXPLANATION OF TERMINOLOGY ON THIS LOG |
|---|------------------|--------------------------|--------------|---------------|--------------|---------------|----------------------|-------------|--|
| 0-12½' | 3.25" HSA | DATE | TIME | SAMPLED DEPTH | CASING DEPTH | CAVE-IN DEPTH | DRILLING FLUID LEVEL | WATER LEVEL | |
| | | 1/26/18 | 11:40 | 14.5 | 12.5 | 14.5 | | None | |
| | | | | | | | | | |
| BORING COMPLETED: 1/26/18 | | | | | | | | | |
| DR: TA LG: SB Rig: 69C | | | | | | | | | |

AET_CORP 01-07434.GPJ AET+CPT+WELL.GDT 2/9/18



SUBSURFACE BORING LOG

AET No: 01-07434 Log of Boring No. B-5 (p. 1 of 1)
 Project: Westwood Hills Nature Center; St. Louis Park, MN

| DEPTH IN FEET | Surface Elevation <u>892.7</u> MATERIAL DESCRIPTION | GEOLOGY | N | MC | SAMPLE TYPE | REC IN. | FIELD & LABORATORY TESTS | | | | | | | |
|---------------|--|-----------------------------------|----|-----|-------------|---------|--------------------------|-----|----|----|--------|--|--|--|
| | | | | | | | WC | DEN | LL | PL | %-#200 | | | |
| 1 | FILL, mostly clayey sand, a little gravel, trace roots, dark brown, frozen | FILL | | F | SU | | | | | | | | | |
| 2 | FILL, mostly silty sand, a little gravel, dark brown, frozen to 2.5' | | 21 | F/M | SS | 22 | | | | | | | | |
| 3 | | | | | | | | | | | | | | |
| 4 | | | | | | | | | | | | | | |
| 5 | SAPRIC PEAT, black, a lens of fibric peat at 7' (PT) | SWAMP DEPOSIT | 7 | M | SS | 12 | | | | | | | | |
| 6 | | | | | | | | | | | | | | |
| 7 | | | | | | | | | | | | | | |
| 8 | | | | | | | | | | | | | | |
| 9 | HEMIC PEAT, with shells, black (PT) | | 5 | M | SS | 20 | | | | | | | | |
| 10 | | | | | | | | | | | | | | |
| 11 | BOGLIME WITH SILT, gray (OL-OH) | | 3 | M | SS | 24 | | | | | | | | |
| 12 | | | | | | | | | | | | | | |
| 13 | CLAYEY SAND, fine grained, gray, wet, very loose, laminations and lenses of sandy lean clay (SC) | COARSE ALLUVIUM/ SWAMP DEPOSIT | WH | W | SS | 24 | | | | | | | | |
| 14 | | | | | | | | | | | | | | |
| 15 | CLAYEY SAND, a little gravel, gray, firm to stiff, laminations of silty sand (SC) | MIXED ALLUVIUM | 3 | W | SS | 22 | | | | | | | | |
| 16 | | | | | | | | | | | | | | |
| 17 | | | | | | | | | | | | | | |
| 18 | CLAYEY SAND, a little gravel, gray, firm to stiff, laminations of silty sand (SC) | MIXED ALLUVIUM | 8 | W/M | SS | 18 | | | | | | | | |
| 19 | | | | | | | | | | | | | | |
| 20 | | | | | | | | | | | | | | |
| 21 | END OF BORING | *SWAMP DEPOSIT | 12 | M | SS | 16 | 15 | | | | | | | |
| 21 | | | | | | | | | | | | | | |

Draft

AET_CORP 01-07434.GPJ AET+CPT+WELL.GDT 2/9/18

| | | | | | | | | | |
|----------------------------------|-----------------------------------|--------------------------|-------------|---------------|--------------|---------------|----------------------|-------------|--|
| DEPTH: 0-19½' | DRILLING METHOD: 3.25" HSA | WATER LEVEL MEASUREMENTS | | | | | | | NOTE: REFER TO THE ATTACHED SHEETS FOR AN EXPLANATION OF TERMINOLOGY ON THIS LOG |
| | | DATE | TIME | SAMPLED DEPTH | CASING DEPTH | CAVE-IN DEPTH | DRILLING FLUID LEVEL | WATER LEVEL | |
| | | 1/26/18 | 8:00 | 14.5 | 12.5 | 12.8 | | 12.6 | |
| BORING COMPLETED: 1/26/18 | | | | | | | | | |
| DR: TA | LG: SB | Rig: 69C | | | | | | | |



SUBSURFACE BORING LOG

AET No: 01-07434 Log of Boring No. B-6A (p. 1 of 1)
 Project: Westwood Hills Nature Center; St. Louis Park, MN

| DEPTH IN FEET | Surface Elevation <u>893.8</u> MATERIAL DESCRIPTION | GEOLOGY | N | MC | SAMPLE TYPE | REC IN. | FIELD & LABORATORY TESTS | | | | | | | | |
|---------------------|---|-----------------|----|-----|----------------|------------|--------------------------|-----|----|----|--------|--|--|--|--|
| | | | | | | | WC | DEN | LL | PL | %-#200 | | | | |
| 1 | 5" Bituminous pavement | FILL | | F | SU | | | | | | | | | | |
| | FILL, mostly silty sand, a little gravel, dark brown, frozen | | | | F | SU | | | | | | | | | |
| 2 | FILL, mostly silty sand with organic fines, a little gravel, trace roots, light brown and black, frozen to 2.5' | | 15 | F/M | SS | 16 | | | | | | | | | |
| 3 | | | | | | | | | | | | | | | |
| 4 | | | | | | | | | | | | | | | |
| 5 | CLAYEY SAND, a little gravel, trace roots, gray and light brown mottled, firm (SC) | TILL | | M | SS | 16 | 15 | | | | | | | | |
| 6 | SAND, a little gravel, fine to medium grained, light brown and gray, waterbearing, loose (SP) | COARSE ALLUVIUM | 7 | W | SS | 15 | | | | | | | | | |
| 7 | | | | | | | | | | | | | | | |
| 8 | | | | | | | | | | | | | | | |
| 9 | | | | | | | | | | | | | | | |
| 10 | | | 10 | W | SS | 10 | | | | | | | | | |
| 11 | | | | | | | | | | | | | | | |
| 12 | | | | | | | | | | | | | | | |
| 13 | | | | | | | | | | | | | | | |
| 14 | | | 6 | W | SS | 18 | | | | | | | | | |
| END OF BORING | | | | | | | | | | | | | | | |

| DEPTH: | DRILLING METHOD | WATER LEVEL MEASUREMENTS | | | | | | | NOTE: REFER TO THE ATTACHED SHEETS FOR AN EXPLANATION OF TERMINOLOGY ON THIS LOG |
|---------------------------|------------------|--------------------------|------|---------------|--------------|---------------|----------------------|-------------|--|
| 0-12½' | 3.25" HSA | DATE | TIME | SAMPLED DEPTH | CASING DEPTH | CAVE-IN DEPTH | DRILLING FLUID LEVEL | WATER LEVEL | |
| | | 1/24/18 | 1:30 | 9.0 | 7.0 | 7.7 | | 6.8 | |
| | | 1/24/18 | 1:35 | 9.0 | 7.0 | 7.7 | | 6.5 | |
| BORING COMPLETED: 1/24/18 | | | | | | | | | |
| DR: TA LG: SB Rig: 69C | | | | | | | | | |

AET_CORP 01-07434.GPJ AET+CPT+WELL.GDT 2/9/18



SUBSURFACE BORING LOG

AET No: 01-07434

Log of Boring No. B-7 (p. 1 of 1)

Project: Westwood Hills Nature Center; St. Louis Park, MN

| DEPTH IN FEET | Surface Elevation <u>896.6</u> MATERIAL DESCRIPTION | GEOLOGY | N | MC | SAMPLE TYPE | REC IN. | FIELD & LABORATORY TESTS | | | | | | | |
|---------------------|---|--------------------|---|----|----------------|------------|--------------------------|-----|----|----|--------|--|--|--|
| | | | | | | | WC | DEN | LL | PL | %-#200 | | | |
| 1 | FILL, mostly sandy lean clay and clayey sand, a little gravel, trace roots, black, frozen to 2' | FILL | | F | SU | | | | | | | | | |
| 2 | FILL, mostly clayey sand, dark brown | | | | | | | | | | | | | |
| 3 | | | 5 | M | SS | 18 | | | | | | | | |
| 4 | | | | | | | | | | | | | | |
| 5 | | | 5 | M | SS | 24 | | | | | | | | |
| 6 | | | | | | | | | | | | | | |
| 7 | SILTY SAND, a little gravel, fine to medium grained, dark brown, wet, loose (SM) | COARSE ALLUVIUM | | | | | | | | | | | | |
| 8 | | | 5 | W | SS | 14 | | | | | | | | |
| 9 | | | | ▼ | | | | | | | | | | |
| 10 | | | 5 | W | SS | 20 | | | | | | | | |
| 11 | | | | | | | | | | | | | | |
| 12 | SAND, a little gravel, fine to medium grained, light brown, waterbearing, very loose (SP) | | | | | | | | | | | | | |
| 13 | | | 6 | W | SS | 16 | | | | | | | | |
| 14 | END OF BORING | | | | | | | | | | | | | |

AET_CORP 01-07434.GPJ AET+CPT+WELL.GDT 2/9/18

| DEPTH: | DRILLING METHOD | WATER LEVEL MEASUREMENTS | | | | | | | NOTE: REFER TO THE ATTACHED SHEETS FOR AN EXPLANATION OF TERMINOLOGY ON THIS LOG |
|---|------------------|--------------------------|------|------------------|-----------------|------------------|-------------------------|----------------|---|
| 0-12½' | 3.25" HSA | DATE | TIME | SAMPLED DEPTH | CASING DEPTH | CAVE-IN DEPTH | DRILLING FLUID LEVEL | WATER LEVEL | |
| | | 1/25/18 | 1:35 | 11.5 | 9.5 | 9.7 | | 9.4 | |
| | | 1/25/18 | 1:40 | 11.5 | 9.5 | 9.7 | | 9.1 | |
| BORING COMPLETED: 1/25/18 | | | | | | | | | |
| DR: TA LG: SB Rig: 69C | | | | | | | | | |



SUBSURFACE BORING LOG

AET No: 01-07434

Log of Boring No. B-8 (p. 1 of 1)

Project: Westwood Hills Nature Center; St. Louis Park, MN

| DEPTH IN FEET | Surface Elevation <u>895.1</u> MATERIAL DESCRIPTION | GEOLOGY | N | MC | SAMPLE TYPE | REC IN. | FIELD & LABORATORY TESTS | | | | | | | | |
|---------------------|---|-----------------|----|----|----------------|------------|--------------------------|-----|----|----|--------|--|--|--|--|
| | | | | | | | WC | DEN | LL | PL | %-#200 | | | | |
| 1 | FILL, mostly clayey sand and sandy lean clay, a little gravel, trace roots, black, frozen to 2' | FILL | | F | SU | | | | | | | | | | |
| 2 | FILL, mostly clayey sand and sandy lean clay, black and brown | | 7 | M | SS | 18 | | | | | | | | | |
| 3 | | | | | | | | | | | | | | | |
| 4 | | | | | | | | | | | | | | | |
| 5 | CLAYEY SAND, a little gravel, brown to light brown, stiff to firm (SC) | TILL | 12 | M | SS | 15 | 20 | | | | | | | | |
| 6 | CLAYEY SAND, a little gravel, brown to light brown, stiff to firm (SC) | TILL | 12 | M | SS | 15 | 20 | | | | | | | | |
| 7 | | | | | | | | | | | | | | | |
| 8 | | | | | | | | | | | | | | | |
| 9 | | | | | | | | | | | | | | | |
| 10 | | | | | | | | | | | | | | | |
| 11 | | | | | | | | | | | | | | | |
| 12 | | | 8 | M | SS | 18 | | | | | | | | | |
| 13 | SILTY GRAVEL WITH SAND, medium to coarse grained, light brown, wet, medium dense (GM) | COARSE ALLUVIUM | 15 | W | SS | 16 | | | | | | | | | |
| 14 | SAND, a little gravel, fine to medium grained, light brown, waterbearing, medium dense (SP) | COARSE ALLUVIUM | 15 | W | SS | 16 | | | | | | | | | |
| 15 | | | | | | | | | | | | | | | |
| 16 | | | | | | | | | | | | | | | |
| 17 | | | | | | | | | | | | | | | |
| 18 | | | | | | | | | | | | | | | |
| 19 | | | | | | | | | | | | | | | |
| 20 | | | 13 | W | SS | 18 | | | | | | | | | |
| 21 | END OF BORING | | | | | | | | | | | | | | |

AET_CORP 01-07434.GPJ AET+CPT+WELL.GDT 2/9/18

| DEPTH: | DRILLING METHOD | WATER LEVEL MEASUREMENTS | | | | | | | NOTE: REFER TO THE ATTACHED SHEETS FOR AN EXPLANATION OF TERMINOLOGY ON THIS LOG |
|---|------------------|--------------------------|-------|---------------|--------------|---------------|----------------------|-------------|--|
| 0-19½' | 3.25" HSA | DATE | TIME | SAMPLED DEPTH | CASING DEPTH | CAVE-IN DEPTH | DRILLING FLUID LEVEL | WATER LEVEL | |
| | | 1/25/18 | 12:30 | 14.5 | 12.5 | 12.2 | | 8.8 | |
| | | 1/25/18 | 12:35 | 14.5 | 12.5 | 12.2 | | 7.9 | |
| BORING COMPLETED: 1/25/18 | | | | | | | | | |
| DR: TA LG: SB Rig: 69C | | | | | | | | | |



SUBSURFACE BORING LOG

AET No: 01-07434 Log of Boring No. B-9 (p. 1 of 1)
 Project: Westwood Hills Nature Center; St. Louis Park, MN

| DEPTH IN FEET | Surface Elevation <u>895.0</u> MATERIAL DESCRIPTION | GEOLOGY | N | MC | SAMPLE TYPE | REC IN. | FIELD & LABORATORY TESTS | | | | | | | |
|---------------|---|-----------------|----|-----|-------------|---------|--------------------------|-----|----|----|--------|--|--|--|
| | | | | | | | WC | DEN | LL | PL | %-#200 | | | |
| 1 | FILL, mostly sand with silt, a little gravel, trace roots, dark brown, frozen to 2.5' | FILL | | | | | | | | | | | | |
| 2 | | | | F | SU | | | | | | | | | |
| 3 | | | 13 | F/M | SS | 12 | | | | | | | | |
| 4 | | | | | | | | | | | | | | |
| 5 | ORGANIC CLAY, trace roots, black to gray, firm (OH) | SWAMP DEPOSIT | | | | | | | | | | | | |
| 6 | | | 6 | M | SS | 12 | | | | | | | | |
| 7 | | | | | | | | | | | | | | |
| 8 | | | 6 | M | SS | 20 | | | | | | | | |
| 9 | | | | | | | | | | | | | | |
| 10 | BOGLIME WITH SILT, gray, trace roots (OL-OH) | | | | | | | | | | | | | |
| 11 | | | 5 | M | SS | 13 | | | | | | | | |
| 12 | | | | | | | | | | | | | | |
| 13 | | | | | | | | | | | | | | |
| 14 | | | | | | | | | | | | | | |
| 15 | | | | | | | | | | | | | | |
| 16 | | | | | | | | | | | | | | |
| 17 | | | | | | | | | | | | | | |
| 18 | | | | | | | | | | | | | | |
| 19 | | | | | | | | | | | | | | |
| 20 | SAND, a little gravel, fine to medium grained, gray, waterbearing, loose (SP) | COARSE ALLUVIUM | | | | | | | | | | | | |
| 21 | | | 15 | W | SS | 12 | | | | | | | | |
| 21 | END OF BORING | | | | | | | | | | | | | |

Draft

| DEPTH: | DRILLING METHOD | WATER LEVEL MEASUREMENTS | | | | | | | NOTE: REFER TO THE ATTACHED SHEETS FOR AN EXPLANATION OF TERMINOLOGY ON THIS LOG |
|---|------------------|--------------------------|--------------|---------------|--------------|---------------|----------------------|-------------|--|
| | | DATE | TIME | SAMPLED DEPTH | CASING DEPTH | CAVE-IN DEPTH | DRILLING FLUID LEVEL | WATER LEVEL | |
| 0-19½' | 3.25" HSA | 1/25/18 | 10:55 | 21.0 | 19.5 | 19.0 | | 10.8 | |
| | | 1/25/18 | 11:00 | 21.0 | 19.5 | 19.0 | | 9.0 | |
| BORING COMPLETED: 1/25/18 | | | | | | | | | |
| DR: TA LG: SB Rig: 69C | | | | | | | | | |

AET_CORP 01-07434.GPJ AET+CPT+WELL.GDT 2/9/18



SUBSURFACE BORING LOG

AET No: 01-07434

Log of Boring No. B-10 (p. 1 of 1)

Project: Westwood Hills Nature Center; St. Louis Park, MN

| DEPTH IN FEET | Surface Elevation <u>893.9</u> MATERIAL DESCRIPTION | GEOLOGY | N | MC | SAMPLE TYPE | REC IN. | FIELD & LABORATORY TESTS | | | | | | | | | | | |
|---------------|---|-----------------|----|-----|-------------|---------|--------------------------|-----|----|----|--------|--|--|--|--|--|--|--|
| | | | | | | | WC | DEN | LL | PL | %-#200 | | | | | | | |
| 1 | 6" Bituminous pavement | FILL | | F | SU | | | | | | | | | | | | | |
| 2 | FILL, mostly silty sand, a little gravel, dark brown to light brown, frozen | | | | F | SU | | | | | | | | | | | | |
| 3 | HEMIC PEAT, laminations of sand, black, frozen to 3.5' (PT) | SWAMP DEPOSIT | 66 | F | SS | 18 | | | | | | | | | | | | |
| 4 | | | | | | | | | | | | | | | | | | |
| 5 | | | | | | | | | | | | | | | | | | |
| 6 | | | 8 | M | SS | 5 | | | | | | | | | | | | |
| 7 | SILTY SAND, a little gravel, fine to medium grained, gray, moist, loose (SM) | COARSE ALLUVIUM | 9 | W/M | SS | 6 | | | | | | | | | | | | |
| 8 | | | | | | | | | | | | | | | | | | |
| 9 | | | | | | | | | | | | | | | | | | |
| 10 | SAND, fine to medium grained, light brown, waterbearing, very loose to loose (SP) | | 2 | W | SS | 10 | | | | | | | | | | | | |
| 11 | | | | | | | | | | | | | | | | | | |
| 12 | | | | | | | | | | | | | | | | | | |
| 13 | | | | | | | | | | | | | | | | | | |
| 14 | | | 5 | W | SS | 15 | | | | | | | | | | | | |
| 15 | | | | | | | | | | | | | | | | | | |
| 16 | | | | | | | | | | | | | | | | | | |
| 17 | | | | | | | | | | | | | | | | | | |
| 18 | | | | | | | | | | | | | | | | | | |
| 19 | | | | | | | | | | | | | | | | | | |
| 20 | SAND WITH GRAVEL, fine to medium grained, light gray, waterbearing, loose (SP) | | 10 | W | SS | 16 | | | | | | | | | | | | |
| 21 | END OF BORING | | | | | | | | | | | | | | | | | |

AET_CORP 01-07434.GPJ AET+CPT+WELL.GDT 2/9/18

Draft

| DEPTH: | DRILLING METHOD | WATER LEVEL MEASUREMENTS | | | | | | | NOTE: REFER TO THE ATTACHED SHEETS FOR AN EXPLANATION OF TERMINOLOGY ON THIS LOG |
|---|------------------|--------------------------|-------|---------------|--------------|---------------|----------------------|-------------|--|
| 0-19½' | 3.25" HSA | DATE | TIME | SAMPLED DEPTH | CASING DEPTH | CAVE-IN DEPTH | DRILLING FLUID LEVEL | WATER LEVEL | |
| | | 1/24/18 | 10:15 | 11.5 | 9.5 | 9.1 | | 7.6 | |
| | | 1/24/18 | 10:25 | 11.5 | 9.5 | 8.7 | | 6.8 | |
| BORING COMPLETED: 1/24/18 | | | | | | | | | |
| DR: TA LG: SB Rig: 69C | | | | | | | | | |



SUBSURFACE BORING LOG

AET No: 01-07434 Log of Boring No. B-11 (p. 1 of 1)
 Project: Westwood Hills Nature Center; St. Louis Park, MN

| DEPTH IN FEET | Surface Elevation <u>893.2</u> MATERIAL DESCRIPTION | GEOLOGY | N | MC | SAMPLE TYPE | REC IN. | FIELD & LABORATORY TESTS | | | | | | | |
|---------------|---|----------------|----|-----|-------------|---------|--------------------------|-----|----|----|--------|--|--|--|
| | | | | | | | WC | DEN | LL | PL | %-#200 | | | |
| 1 | 6" Bituminous pavement | FILL | | F | SU | | | | | | | | | |
| | FILL, mostly silty sand, a little gravel, dark brown, frozen | | | F | SU | | | | | | | | | |
| 2 | FILL, mostly silty sand, a little gravel, black, frozen | | | | | | | | | | | | | |
| 3 | FILL, mostly clayey sand, a little gravel, trace roots, black, frozen to 3.5' | | 68 | F/M | SS | 24 | | | | | | | | |
| 4 | | | | | | | | | | | | | | |
| 5 | SAPRIC PEAT, a little gravel, black, laminations of sand (PT) | SWAMP DEPOSIT | | M | SS | 8 | | | | | | | | |
| 6 | | | | | | | | | | | | | | |
| 7 | ORGANIC SANDY LEAN TO FAT, a little gravel, black to gray, soft (OL-OH) | | | | | | | | | | | | | |
| 8 | | | 4 | W/M | SS | 20 | | | | | | | | |
| 9 | | | | | | | | | | | | | | |
| 10 | CLAYEY SAND, a little gravel, gray, soft to firm (SC) | MIXED ALLUVIUM | | W/M | SS | 20 | 21 | | | | | | | |
| 11 | | | 4 | W/M | SS | 20 | | | | | | | | |
| 12 | | | | | | | | | | | | | | |
| 13 | | | | | | | | | | | | | | |
| 14 | | | 5 | W/M | SS | 16 | 21 | | | | | | | |
| 15 | | | | | | | | | | | | | | |
| 16 | | | | | | | | | | | | | | |
| 17 | | | | | | | | | | | | | | |
| 18 | | | | | | | | | | | | | | |
| 19 | | | | | | | | | | | | | | |
| 20 | SILTY SAND, a little gravel, fine to medium grained, gray, wet, loose (SM) | | 9 | W/M | SS | 10 | | | | | | | | |
| 21 | END OF BORING | | | | | | | | | | | | | |

| DEPTH: | DRILLING METHOD | WATER LEVEL MEASUREMENTS | | | | | | | NOTE: REFER TO THE ATTACHED SHEETS FOR AN EXPLANATION OF TERMINOLOGY ON THIS LOG |
|---------------------------|------------------|--------------------------|-------|---------------|--------------|---------------|----------------------|-------------|--|
| 0-19½' | 3.25" HSA | DATE | TIME | SAMPLED DEPTH | CASING DEPTH | CAVE-IN DEPTH | DRILLING FLUID LEVEL | WATER LEVEL | |
| | | 1/24/18 | 12:20 | 11.5 | 9.5 | 9.3 | | 7.7 | |
| | | 1/24/18 | 12:30 | 11.5 | 9.5 | 9.3 | | 7.0 | |
| BORING COMPLETED: 1/24/18 | | | | | | | | | |
| DR: TA LG: SB Rig: 69C | | | | | | | | | |

AET_CORP 01-07434.GPJ AET+CPT+WELL.GDT 2/9/18



SUBSURFACE BORING LOG

AET No: 01-07434 Log of Boring No. B-12 (p. 1 of 1)
 Project: Westwood Hills Nature Center; St. Louis Park, MN

| DEPTH IN FEET | Surface Elevation <u>893.6</u> MATERIAL DESCRIPTION | GEOLOGY | N | MC | SAMPLE TYPE | REC IN. | FIELD & LABORATORY TESTS | | | | | | | | |
|---------------|---|-----------------|----|-----|-------------|---------|--------------------------|-----|----|----|--------|--|--|--|--|
| | | | | | | | WC | DEN | LL | PL | %-#200 | | | | |
| 1 | FILL, mostly clayey sand and silty sand, a little gravel, trace roots, brown to black, frozen to 2' | FILL | | | | | | | | | | | | | |
| 2 | | | | F | SU | | | | | | | | | | |
| 3 | | | | 8 | M | SS | 16 | | | | | | | | |
| 4 | | | | | | | | | | | | | | | |
| 5 | SAPRIC PEAT, black (PT) | SWAMP DEPOSIT | | | | | | | | | | | | | |
| 6 | | | 10 | | SS | 14 | | | | | | | | | |
| 7 | SILTY SAND, a little gravel, fine to medium grained, gray, moist, loose, a lens of clayey sand (SM) | COARSE ALLUVIUM | | | | | | | | | | | | | |
| 8 | | | 7 | W/M | SS | 13 | | | | | | | | | |
| 9 | | | | | | | | | | | | | | | |
| 10 | SAND, fine to medium grained, gray, waterbearing, loose (SP) | | | | | | | | | | | | | | |
| 11 | | | 6 | W | SS | 18 | | | | | | | | | |
| 12 | | | | | | | | | | | | | | | |
| 13 | SAND, a little gravel, fine to coarse grained, gray, waterbearing, very dense (SP) | | | | | | | | | | | | | | |
| 14 | | | 54 | W | SS | 10 | | | | | | | | | |
| 15 | | | | | | | | | | | | | | | |
| 16 | | | | | | | | | | | | | | | |
| 17 | | | | | | | | | | | | | | | |
| 18 | | | | | | | | | | | | | | | |
| 19 | | | | | | | | | | | | | | | |
| 20 | SAND, fine to medium grained, gray, waterbearing, loose (SP) | | | | | | | | | | | | | | |
| 21 | END OF BORING | | | | | | | | | | | | | | |

| DEPTH: | DRILLING METHOD | WATER LEVEL MEASUREMENTS | | | | | | | NOTE: REFER TO THE ATTACHED SHEETS FOR AN EXPLANATION OF TERMINOLOGY ON THIS LOG |
|---------------------------|------------------|--------------------------|------|---------------|--------------|---------------|----------------------|-------------|--|
| 0-19½' | 3.25" HSA | DATE | TIME | SAMPLED DEPTH | CASING DEPTH | CAVE-IN DEPTH | DRILLING FLUID LEVEL | WATER LEVEL | |
| | | 1/24/18 | 2:00 | 11.5 | 9.5 | 8.7 | | 6.9 | |
| | | 1/25/18 | 8:15 | 11.5 | 9.5 | 8.3 | | 5.5 | |
| BORING COMPLETED: 1/24/18 | | | | | | | | | |
| DR: TA LG: SB Rig: 69C | | | | | | | | | |

AET_CORP_01-07434.GPJ_AET+CPT+WELL.GDT_2/9/18



SUBSURFACE BORING LOG

AET No: **01-07434**

Log of Boring No. **B-13 (p. 1 of 1)**

Project: **Westwood Hills Nature Center; St. Louis Park, MN**

| DEPTH IN FEET | Surface Elevation 893.8 MATERIAL DESCRIPTION | GEOLOGY | N | MC | SAMPLE TYPE | REC IN. | FIELD & LABORATORY TESTS | | | | | | | | |
|---------------------|--|--------------------|----|----|----------------|------------|--------------------------|-----|----|----|--------|--|--|--|--|
| | | | | | | | WC | DEN | LL | PL | %-#200 | | | | |
| 1 | FILL, mostly clayey sand, a little gravel, trace roots, dark brown, frozen to 2' | FILL | | | SU | | | | | | | | | | |
| 2 | SAPRIC PEAT, black, laminations of sand (PT) | SWAMP DEPOSIT | 6 | M | SS | 8 | | | | | | | | | |
| 3 | | | | | | | | | | | | | | | |
| 4 | | | | | | | | | | | | | | | |
| 5 | CLAYEY SAND, a little gravel, trace roots, firm, a lens of silty sand (SC) | MIXED ALLUVIUM | 8 | M | SS | 22 | 16 | | | | | | | | |
| 6 | | | | | | | | | | | | | | | |
| 7 | SAND, fine to medium grained, light brown and gray, waterbearing, loose to very loose to medium dense (SP) | COARSE ALLUVIUM | 6 | W | SS | 20 | | | | | | | | | |
| 8 | | | | | | | | | | | | | | | |
| 9 | | | | | | | | | | | | | | | |
| 10 | | | | | | | | | | | | | | | |
| 11 | | | | | | | | | | | | | | | |
| 12 | | | | | | | | | | | | | | | |
| 13 | 2 | W | SS | 13 | | | | | | | | | | | |
| 14 | | | | | | | | | | | | | | | |
| 15 | 22 | W | SS | 15 | | | | | | | | | | | |
| 16 | | | | | | | | | | | | | | | |
| 17 | | | | | | | | | | | | | | | |
| 18 | | | | | | | | | | | | | | | |
| 19 | | | | | | | | | | | | | | | |
| 20 | | | | | | | | | | | | | | | |
| 21 | END OF BORING | | | | | | | | | | | | | | |

Draft

AET_CORP 01-07434.GPJ AET+CPT+WELL.GDT 2/9/18

| DEPTH: | DRILLING METHOD | WATER LEVEL MEASUREMENTS | | | | | | | NOTE: REFER TO THE ATTACHED SHEETS FOR AN EXPLANATION OF TERMINOLOGY ON THIS LOG |
|---|------------------|--------------------------|-------------|------------------|-----------------|------------------|-------------------------|----------------|---|
| 0-19½' | 3.25" HSA | DATE | TIME | SAMPLED DEPTH | CASING DEPTH | CAVE-IN DEPTH | DRILLING FLUID LEVEL | WATER LEVEL | |
| | | 1/25/18 | 9:20 | 9.0 | 7.0 | 7.4 | | 6.7 | |
| | | 1/25/18 | 9:25 | 9.0 | 7.0 | 7.4 | | 6.5 | |
| BORING COMPLETED: 1/25/18 | | | | | | | | | |
| DR: TA LG: SB Rig: 69C | | | | | | | | | |



SUBSURFACE BORING LOG

AET No: 01-07434 Log of Boring No. B-14 (p. 1 of 1)
 Project: Westwood Hills Nature Center; St. Louis Park, MN

| DEPTH IN FEET | Surface Elevation <u>897.4</u> MATERIAL DESCRIPTION | GEOLOGY | N | MC | SAMPLE TYPE | REC IN. | FIELD & LABORATORY TESTS | | | | | | | |
|---------------------|---|-----------------|----|-----|----------------|------------|--------------------------|-----|----|----|--------|--|--|--|
| | | | | | | | WC | DEN | LL | PL | %-#200 | | | |
| 1 | FILL, mostly silty sand, a little gravel, piece of bituminous pavement, dark brown, frozen | FILL | | | SU | | | | | | | | | |
| 2 | SAND WITH SILT, a little gravel, fine to medium grained, light brown, frozen to 3.5' (SP-SM) | COARSE ALLUVIUM | 64 | F/M | SS | 24 | | | | | | | | |
| 3 | | | | | | | | | | | | | | |
| 4 | SAND WITH SILT, a little gravel, fine to medium grained, tan to light brown, moist, medium dense, a lens of clayey sand (SP-SM) | | 12 | M | SS | 18 | | | | | | | | |
| 5 | | | | | | | | | | | | | | |
| 6 | CLAYEY SAND WITH GRAVEL, fine to medium grained, light brown, moist, medium dense (SP) | | 15 | M | SS | 6 | | | | | | | | |
| 7 | | | | | | | | | | | | | | |
| 8 | SILTY SAND, a little gravel, fine to medium grained, light brown, wet, loose (SM) | | 5 | W | SS | 10 | | | | | | | | |
| 9 | | | | | | | | | | | | | | |
| 10 | SAND, fine to medium grained, light brown, wet, loose (SP) | | 6 | W | SS | 22 | | | | | | | | |
| 11 | | | | | | | | | | | | | | |
| 12 | END OF BORING | | | | | | | | | | | | | |
| 13 | | | | | | | | | | | | | | |
| 14 | | | | | | | | | | | | | | |

| DEPTH: | DRILLING METHOD | WATER LEVEL MEASUREMENTS | | | | | | | NOTE: REFER TO THE ATTACHED SHEETS FOR AN EXPLANATION OF TERMINOLOGY ON THIS LOG |
|---|------------------|--------------------------|-------|---------------|--------------|---------------|----------------------|-------------|--|
| 0-12½' | 3.25" HSA | DATE | TIME | SAMPLED DEPTH | CASING DEPTH | CAVE-IN DEPTH | DRILLING FLUID LEVEL | WATER LEVEL | |
| | | 1/25/18 | 10:05 | 11.5 | 9.5 | 10.0 | | 9.8 | |
| | | 1/25/18 | 10:10 | 11.5 | 9.5 | 9.9 | | 9.5 | |
| BORING COMPLETED: 1/25/18 | | | | | | | | | |
| DR: TA LG: SB Rig: 69C | | | | | | | | | |

AET_CORP 01-07434.GPJ AET+CPT+WELL.GDT 2/9/18

Appendix C

Cost Estimates



ENGINEER'S OPINION OF PROBABLE PROJECT COST

PROJECT: Westwood Lake Water Quality Improvement Project
 LOCATION: St. Louis Park, MN
 PROJECT #: 23/27-0051.40

OPINION OF COST - SUMMARY

| | | | |
|--------------|---------------------------------|-------|----------|
| BY: | JPP | DATE: | 5/7/2018 |
| CHECKED BY: | MAK | DATE: | 5/7/2018 |
| APPROVED BY: | KAL | DATE: | 5/7/2018 |
| ISSUED: | For BCWMC/St. Louis Park Review | DATE: | 5/7/2018 |
| ISSUED: | | DATE: | |
| ISSUED: | | DATE: | |
| ISSUED: | | DATE: | |

**Engineer's Opinion of Probable Project Cost
 Concept 1 - ADDITIONAL PERMEABLE PAVERS**

| Item. No. | ITEM DESCRIPTION | UNIT | ESTIMATED QUANTITY | UNIT COST | ITEM COST | NOTES |
|-----------|---|------|--------------------|-------------|---------------------|-----------------|
| A | MOBILIZATION/DEMobilIZATION (5%) | LS | 1 | \$2,500.00 | \$2,500.00 | 1,2,3,4,5,6,7,8 |
| B | EROSION AND SEDIMENT CONTROL | LS | 1 | \$500.00 | \$500.00 | 1,2,3,4,5,6,7,8 |
| C | TRAFFIC CONTROL | LS | 1 | \$500.00 | \$500.00 | 1,2,3,4,5,6,7,8 |
| D | GEOTEXTILE FABRIC | SY | 1,000 | \$2.50 | \$2,500.00 | 1,2,3,4,5,6,7,8 |
| E | 6" CPEP SLOTTED UNDERDRAIN (SMOOTH INTERIOR) & FITTINGS | LF | 400 | \$18.00 | \$7,200.00 | 1,2,3,4,5,6,7,8 |
| F | 6" SCHEDULE 40 SOLID POLYVINYL CHLORIDE (PVC) PIPE & FITTINGS | LF | 120 | \$18.00 | \$2,160.00 | 1,2,3,4,5,6,7,8 |
| G | UNDERDRAIN CLEANOUT & COVER UNIT | EA | 3 | \$300.00 | \$900.00 | 1,2,3,4,5,6,7,8 |
| H | CLEAN WASHED SAND (IN PLACE) | CY | 30 | \$60.00 | \$1,800.00 | 1,2,3,4,5,6,7,8 |
| I | 2"-4" ASTM #3 CRUSHED GRANITE (STRUCTURAL COURSE) | TON | 250 | \$40.00 | \$10,000.00 | 1,2,3,4,5,6,7,8 |
| J | 1" ASTM #57 CRUSHED GRANITE (BASE COURSE) | TON | 230 | \$40.00 | \$9,200.00 | 1,2,3,4,5,6,7,8 |
| K | PERMEABLE PAVERS WITH BEDDING COURSE (3/8" ASTM #8 CRUSHED GRANITE) AND JOINT FILLER (1/4" ASTM #9 CRUSHED GRANITE) | SF | 6,300 | \$6.00 | \$37,800.00 | 1,2,3,4,5,6,7,8 |
| L | CONCRETE RIBBON CURB AT PERMEABLE PAVERS | LF | 380 | \$20.00 | \$7,600.00 | 1,2,3,4,5,6,7,8 |
| M | SITE RESTORATION | AC | 0.1 | \$4,500.00 | \$415.57 | 1,2,3,4,5,6,7,8 |
| N | OVERFLOW STRUCTURE - 48" CB | EA | 3 | \$2,500.00 | \$7,500.00 | 1,2,3,4,5,6,7,8 |
| O | 12" STORM SEWER | LF | 200 | \$35.00 | \$7,000.00 | 1,2,3,4,5,6,7,8 |
| P | SIGNAGE - 1 SIGN | LS | 1 | \$3,000.00 | \$3,000.00 | 1,2,3,4,5,6,7,8 |
| | CONSTRUCTION SUBTOTAL | | | | \$101,000.00 | 1,2,3,4,5,6,7,8 |
| | CONSTRUCTION CONTINGENCY (30%) | | | | \$30,000.00 | 1,5,8 |
| | ESTIMATED CONSTRUCTION COST | | | | \$131,000.00 | 1,2,3,4,5,6,7,8 |
| | PLANNING, ENGINEERING & DESIGN (30%) | | | | \$39,000.00 | 1,2,3,4,5,8 |
| | ESTIMATED TOTAL PROJECT COST | | | | \$170,000.00 | 1,2,3,4,5,7,8 |
| | ESTIMATED ACCURACY RANGE | | | -20% | \$136,000.00 | 5,7,8 |
| | | | | 30% | \$221,000.00 | 5,7,8 |

Notes

- ¹ Limited Design Work Completed (10 - 15%).
- ² Quantities Based on Design Work Completed.
- ³ Unit Prices Based on Information Available at This Time.
- ⁴ Limited Field Investigation Completed.
- ⁵ This feasibility-level (Class 4, 10-15% design completion per ASTM E 2516-06) cost estimate is based on feasibility-level designs, alignments, quantities and unit prices. Costs will change with further design. Time value-of-money escalation costs are not included. A construction schedule is not available at this time. Contingency is an allowance for the net sum of costs that will be in the Final Total Project Cost at the time of the completion of design, but are not included at this level of project definition. The estimated accuracy range for the Total Project Cost as the project is defined is -20% to +30%. The accuracy range is based on professional judgement considering the level of design completed, the complexity of the project and the uncertainties in the project as scoped. The contingency and the accuracy range are not intended to include costs for future scope changes that are not part of the project as currently scoped or costs for risk contingency. Operation and Maintenance costs are not included.
- ⁶ Estimate assumes that projects will not be located on contaminated soil. No costs included for soil correction or overexcavation.
- ⁷ Estimate costs are to design, construct, and permit each alternative. The estimated costs do not include maintenance, monitoring or
- ⁸ Estimate costs are reported to nearest thousand dollars.



ENGINEER'S OPINION OF PROBABLE PROJECT COST

PROJECT: Westwood Lake Water Quality Improvement Project
 LOCATION: St. Louis Park, MN
 PROJECT #: 23/27-0051.40

OPINION OF COST - SUMMARY

| | | | |
|--------------|---------------------------------|-------|----------|
| BY: | JPP | DATE: | 5/7/2018 |
| CHECKED BY: | MAK | DATE: | 5/7/2018 |
| APPROVED BY: | KAL | DATE: | 5/7/2018 |
| ISSUED: | For BCWMC/St. Louis Park Review | DATE: | 5/7/2018 |
| ISSUED: | | DATE: | |
| ISSUED: | | DATE: | |
| ISSUED: | | DATE: | |

**Engineer's Opinion of Probable Project Cost
 Concept 2 - EXPAND FILTRATION BASINS**

| Item. No. | ITEM DESCRIPTION | UNIT | ESTIMATED QUANTITY | UNIT COST | ITEM COST | NOTES |
|-----------|---|------|--------------------|------------|--------------------|-----------------|
| A | MOBILIZATION/DEMobilIZATION (5%) | LS | 1 | \$2,200.00 | \$2,200.00 | 1,2,3,4,5,6,7,8 |
| B | EROSION AND SEDIMENT CONTROL | LS | 1 | \$1,000.00 | \$1,000.00 | 1,2,3,4,5,6,7,8 |
| C | TRAFFIC CONTROL | LS | 1 | \$500.00 | \$500.00 | 1,2,3,4,5,6,7,8 |
| D | COMMON EXCAVATION (IN-PLACE) | CY | 168 | \$7.50 | \$1,262.50 | 1,2,3,4,5,6,7,8 |
| E | DISPOSE OF EXCAVATED MATERIALS OFF-SITE (IN-PLACE) | CY | 168 | \$12.00 | \$2,020.00 | 1,2,3,4,5,6,7,8 |
| F | 12" CPEP STORM SEWER | LF | 125 | \$25.00 | \$3,125.00 | 1,2,3,4,5,6,7,8 |
| H | 6" CPEP SLOTTED UNDERDRAIN (SMOOTH INTERIOR) & FITTINGS | LF | 95 | \$18.00 | \$1,710.00 | 1,2,3,4,5,6,7,8 |
| I | UNDERDRAIN CLEANOUT & COVER UNIT | EA | 2 | \$300.00 | \$600.00 | 1,2,3,4,5,6,7,8 |
| J | CLEAN WASHED SAND | CY | 95 | \$60.00 | \$5,700.00 | 1,2,3,4,5,6,7,8 |
| K | GEOTEXTILE FILTER - MnDOT TYPE V | SY | 17 | \$20.00 | \$340.00 | 1,2,3,4,5,6,7,8 |
| L | GRANULAR FILTER MATERIAL | TON | 0.4 | \$200.00 | \$80.00 | 1,2,3,4,5,6,7,8 |
| M | RIPRAP - MnDOT CLASS II | TON | 12 | \$60.00 | \$720.00 | 1,2,3,4,5,6,7,8 |
| N | PERFORM SOIL LOOSENING | SY | 116 | \$4.00 | \$465.33 | 1,2,3,4,5,6,7,8 |
| O | PLANTING SOIL (IN-PLACE) | CY | 109 | \$50.00 | \$5,451.85 | 1,2,3,4,5,6,7,8 |
| P | PLANTINGS | EACH | 1,060 | \$3.50 | \$3,710.00 | 1,2,3,4,5,6,7,8 |
| Q | DOUBLE SHREDDED HARDWOOD MULCH | CY | 27 | \$65.00 | \$1,771.85 | 1,2,3,4,5,6,7,8 |
| R | 4" BLACK STEEL LANDSCAPE EDGING | LF | 273 | \$10.00 | \$2,730.00 | 1,2,3,4,5,6,7,8 |
| S | SITE RESTORATION | AC | 0.07 | \$4,500.00 | \$334.30 | 1,2,3,4,5,6,7,8 |
| T | SIGNAGE - 1 SIGN | LS | 1 | \$3,000.00 | \$3,000.00 | 1,2,3,4,5,6,7,8 |
| | CONSTRUCTION SUBTOTAL | | | | \$37,000.00 | 1,2,3,4,5,6,7,8 |
| | CONSTRUCTION CONTINGENCY (30%) | | | | \$11,000.00 | 1,5,8 |
| | ESTIMATED CONSTRUCTION COST | | | | \$48,000.00 | 1,2,3,4,5,6,7,8 |
| | PLANNING, ENGINEERING & DESIGN (30%) | | | | \$14,000.00 | 1,2,3,4,5,8 |
| | ESTIMATED TOTAL PROJECT COST | | | | \$62,000.00 | 1,2,3,4,5,7,8 |
| | ESTIMATED ACCURACY RANGE | | -20% | | \$50,000.00 | 5,7,8 |
| | | | 30% | | \$81,000.00 | 5,7,8 |

Notes

- ¹ Limited Design Work Completed (10 - 15%).
- ² Quantities Based on Design Work Completed.
- ³ Unit Prices Based on Information Available at This Time.
- ⁴ Limited Field Investigation Completed.
- ⁵ This feasibility-level (Class 4, 10-15% design completion per ASTM E 2516-06) cost estimate is based on feasibility-level designs, alignments, quantities and unit prices. Costs will change with further design. Time value-of-money escalation costs are not included. A construction schedule is not available at this time. Contingency is an allowance for the net sum of costs that will be in the Final Total Project Cost at the time of the completion of design, but are not included at this level of project definition. The estimated accuracy range for the Total Project Cost as the project is defined is -20% to +30%. The accuracy range is based on professional judgement considering the level of design completed, the complexity of the project and the uncertainties in the project as scoped. The contingency and the accuracy range are not intended to include costs for future scope changes that are not part of the project as currently scoped or costs for risk contingency. Operation and Maintenance costs are not included.
- ⁶ Estimate assumes that projects will not be located on contaminated soil.
- ⁷ Estimate costs are to design, construct, and permit each alternative. The estimated costs do not include maintenance, monitoring or
- ⁸ Estimate costs are reported to nearest thousand dollars.



ENGINEER'S OPINION OF PROBABLE PROJECT COST

PROJECT: Westwood Lake Water Quality Improvement Project
 LOCATION: St. Louis Park, MN
 PROJECT #: 23/27-0051.40

OPINION OF COST - SUMMARY

| | | | |
|--------------|---------------------------------|-------|----------|
| BY: | JPP | DATE: | 5/7/2018 |
| CHECKED BY: | MAK | DATE: | 5/7/2018 |
| APPROVED BY: | KAL | DATE: | 5/7/2018 |
| ISSUED: | For BCWMC/St. Louis Park Review | DATE: | 5/7/2018 |
| ISSUED: | | DATE: | |
| ISSUED: | | DATE: | |
| ISSUED: | | DATE: | |

**Engineer's Opinion of Probable Project Cost
 Concept 3 - LINEAR WATER FEATURE**

| Item. No. | ITEM DESCRIPTION | UNIT | ESTIMATED QUANTITY | UNIT COST | ITEM COST | NOTES |
|-----------|--|------|--------------------|-------------|---------------------|-----------------|
| A | MOBILIZATION/DEMOBILIZATION (5%) | LS | 1 | \$13,000.00 | \$13,000.00 | 1,2,3,4,5,6,7,8 |
| B | EROSION AND SEDIMENT CONTROL | LS | 1 | \$1,000.00 | \$1,000.00 | 1,2,3,4,5,6,7,8 |
| C | TRAFFIC CONTROL | LS | 1 | \$500.00 | \$500.00 | 1,2,3,4,5,6,7,8 |
| D | BASIN AND CREEK BED EXCAVATION, FILL, DROP STRUCTURES, OVERFLOWS, MULCH, PLANTS, AND RESTORATION | SF | 6,000 | \$15.00 | \$90,000.00 | 1,2,3,4,5,6,7,8 |
| E | 24" CPEP STORM SEWER | LF | 268 | \$45.00 | \$12,060.00 | 1,2,3,4,5,6,7,8 |
| F | SOLAR POWER SUBMERSIBLE PUMP & CONNECTIONS | LS | 1 | \$10,000.00 | \$10,000.00 | 1,2,3,4,5,6,7,8 |
| G | KID POWER SUBMERSIBLE PUMP & CONNECTIONS | LS | 1 | \$10,000.00 | \$10,000.00 | 1,2,3,4,5,6,7,8 |
| H | KID POWER SITE FEATURES | LS | 1 | \$25,000.00 | \$25,000.00 | 1,2,3,4,5,6,7,8 |
| I | 10' DIAMETER MANHOLE STRUCTURE, 10' DEPTH | EA | 1 | \$25,000.00 | \$25,000.00 | 1,2,3,4,5,6,7,8 |
| J | 10' DIAMETER MANHOLE STRUCTURE, 5' DEPTH | EA | 1 | \$15,000.00 | \$15,000.00 | 1,2,3,4,5,6,7,8 |
| K | SIGNAGE - 2 SIGNS | LS | 1 | \$6,000.00 | \$6,000.00 | 1,2,3,4,5,6,7,8 |
| | CONSTRUCTION SUBTOTAL | | | | \$208,000.00 | 1,2,3,4,5,6,7,8 |
| | CONSTRUCTION CONTINGENCY (30%) | | | | \$62,000.00 | 1,5,8 |
| | ESTIMATED CONSTRUCTION COST | | | | \$270,000.00 | 1,2,3,4,5,6,7,8 |
| | PLANNING, ENGINEERING & DESIGN (30%) | | | | \$81,000.00 | 1,2,3,4,5,8 |
| | ESTIMATED TOTAL PROJECT COST | | | | \$351,000.00 | 1,2,3,4,5,7,8 |
| | ESTIMATED ACCURACY RANGE | | -20% | | \$281,000.00 | 5,7,8 |
| | | | 30% | | \$457,000.00 | 5,7,8 |

Notes

- ¹ Limited Design Work Completed (10 - 15%).
- ² Quantities Based on Design Work Completed.
- ³ Unit Prices Based on Information Available at This Time.
- ⁴ Limited Field Investigation Completed.
- ⁵ This feasibility-level (Class 4, 10-15% design completion per ASTM E 2516-06) cost estimate is based on feasibility-level designs, alignments, quantities and unit prices. Costs will change with further design. Time value-of-money escalation costs are not included. A construction schedule is not available at this time. Contingency is an allowance for the net sum of costs that will be in the Final Total Project Cost at the time of the completion of design, but are not included at this level of project definition. The estimated accuracy range for the Total Project Cost as the project is defined is -20% to +30%. The accuracy range is based on professional judgement considering the level of design completed, the complexity of the project and the uncertainties in the project as scoped. The contingency and the accuracy range are not intended to include costs for future scope changes that are not part of the project as currently scoped or costs for risk contingency.
- Operation and Maintenance costs are not included.
- ⁶ Estimate assumes projects will not be located on contaminated soil.
- ⁷ Estimate costs are to design, construct, and permit each alternative. The estimated costs do not include maintenance, monitoring or additional tasks following construction.
- ⁸ Estimate costs are reported to nearest thousand dollars.



ENGINEER'S OPINION OF PROBABLE PROJECT COST

PROJECT: Westwood Lake Water Quality Improvement Project
 LOCATION: St. Louis Park, MN
 PROJECT #: 23/27-0051.40

OPINION OF COST - SUMMARY

| | | | |
|--------------|---------------------------------|-------|----------|
| BY: | JPP | DATE: | 5/7/2018 |
| CHECKED BY: | MAK | DATE: | 5/7/2018 |
| APPROVED BY: | KAL | DATE: | 5/7/2018 |
| ISSUED: | For BCWMC/St. Louis Park Review | DATE: | 5/7/2018 |
| ISSUED: | | DATE: | |
| ISSUED: | | DATE: | |
| ISSUED: | | DATE: | |

**Engineer's Opinion of Probable Project Cost
 Concept 4 - HEATED SIDEWALK**

| Item. No. | ITEM DESCRIPTION | UNIT | ESTIMATED QUANTITY | UNIT COST | ITEM COST | NOTES |
|-----------|--|------|--------------------|--------------|---------------------|-----------------|
| A | MOBILIZATION/DEMobilIZATION (5%) | LS | 1 | \$9,800.00 | \$9,800.00 | 1,2,3,4,5,6,7,8 |
| B | EROSION AND SEDIMENT CONTROL | LS | 1 | \$1,000.00 | \$1,000.00 | 1,2,3,4,5,6,7,8 |
| C | TRAFFIC CONTROL | LS | 1 | \$500.00 | \$500.00 | 1,2,3,4,5,6,7,8 |
| D | HEATED SIDEWALK WITH MECHANICAL AND ELECTRICAL | LS | 1 | \$140,000.00 | \$140,000.00 | 1,2,3,4,5,6,7,8 |
| | CONSTRUCTION SUBTOTAL | | | | \$151,000.00 | 1,2,3,4,5,6,7,8 |
| | CONSTRUCTION CONTINGENCY (30%) | | | | \$45,000.00 | 1,5,8 |
| | ESTIMATED CONSTRUCTION COST | | | | \$196,000.00 | 1,2,3,4,5,6,7,8 |
| | PLANNING, ENGINEERING & DESIGN (30%) | | | | \$59,000.00 | 1,2,3,4,5,8 |
| | ESTIMATED TOTAL PROJECT COST | | | | \$255,000.00 | 1,2,3,4,5,7,8 |
| | ESTIMATED ACCURACY RANGE | | -20% | | \$204,000.00 | 5,7,8 |
| | | | 30% | | \$332,000.00 | 5,7,8 |

Notes

- ¹ Limited Design Work Completed (10 - 15%).
- ² Quantities Based on Design Work Completed.
- ³ Unit Prices Based on Information Available at This Time.
- ⁴ Limited Field Investigation Completed.
- ⁵ This feasibility-level (Class 4, 10-15% design completion per ASTM E 2516-06) cost estimate is based on feasibility-level designs, alignments, quantities and unit prices. Costs will change with further design. Time value-of-money escalation costs are not included. A construction schedule is not available at this time. Contingency is an allowance for the net sum of costs that will be in the Final Total Project Cost at the time of the completion of design, but are not included at this level of project definition. The estimated accuracy range for the Total Project Cost as the project is defined is -20% to +30%. The accuracy range is based on professional judgement considering the level of design completed, the complexity of the project and the uncertainties in the project as scoped. The contingency and the accuracy range are not intended to include costs for future scope changes that are not part of the project as currently scoped or costs for risk contingency. Operation and Maintenance costs are not included.
- ⁶ Estimate assumes projects will not be located on contaminated soil.
- ⁷ Estimate costs are to design, construct, and permit each alternative. The estimated costs do not include maintenance, monitoring or additional tasks following construction. This cost does not include concrete placement or reinforcement, and assumes the system is coordinated with the concrete installation.
- ⁸ Estimate costs are reported to nearest thousand dollars.



ENGINEER'S OPINION OF PROBABLE PROJECT COST

PROJECT: Westwood Lake Water Quality Improvement Project
 LOCATION: St. Louis Park, MN
 PROJECT #: 23/27-0051.40

OPINION OF COST - SUMMARY

| | | | |
|--------------|---------------------------------|-------|----------|
| BY: | JPP | DATE: | 5/7/2018 |
| CHECKED BY: | MAK | DATE: | 5/7/2018 |
| APPROVED BY: | KAL | DATE: | 5/7/2018 |
| ISSUED: | For BCWMC/St. Louis Park Review | DATE: | 5/7/2018 |
| ISSUED: | | DATE: | |
| ISSUED: | | DATE: | |
| ISSUED: | | DATE: | |

**Engineer's Opinion of Probable Project Cost
 Concept 5 - WATER REUSE**

| Item. No. | ITEM DESCRIPTION | UNIT | ESTIMATED QUANTITY | UNIT COST | ITEM COST | NOTES |
|-----------|--------------------------------------|------|--------------------|--------------|---------------------|-----------------|
| A | MOBILIZATION/DEMOBILIZATION (5%) | LS | 1 | \$22,700.00 | \$22,700.00 | 1,2,3,4,5,6,7,8 |
| B | EROSION AND SEDIMENT CONTROL | LS | 1 | \$1,000.00 | \$1,000.00 | 1,2,3,4,5,6,7,8 |
| C | TRAFFIC CONTROL | LS | 1 | \$500.00 | \$500.00 | 1,2,3,4,5,6,7,8 |
| D | WATER REUSE SYSTEM | LS | 1 | \$100,000.00 | \$100,000.00 | 1,2,3,4,5,6,7,8 |
| E | STORAGE, 10,000 GALLONS | LS | 1 | \$50,000.00 | \$50,000.00 | 1,2,3,4,5,6,7,8 |
| | CONSTRUCTION SUBTOTAL | | | | \$174,000.00 | 1,2,3,4,5,6,7,8 |
| | CONSTRUCTION CONTINGENCY (30%) | | | | \$52,000.00 | 1,5,8 |
| | ESTIMATED CONSTRUCTION COST | | | | \$226,000.00 | 1,2,3,4,5,6,7,8 |
| | PLANNING, ENGINEERING & DESIGN (30%) | | | | \$68,000.00 | 1,2,3,4,5,8 |
| | ESTIMATED TOTAL PROJECT COST | | | | \$294,000.00 | 1,2,3,4,5,7,8 |
| | ESTIMATED ACCURACY RANGE | | -20% | | \$236,000.00 | 5,7,8 |
| | | | 30% | | \$383,000.00 | 5,7,8 |

- Notes
- ¹ Limited Design Work Completed (10 - 15%).
 - ² Quantities Based on Design Work Completed.
 - ³ Unit Prices Based on Information Available at This Time.
 - ⁴ Limited Field Investigation Completed.
 - ⁵ This feasibility-level (Class 4, 10-15% design completion per ASTM E 2516-06) cost estimate is based on feasibility-level designs, alignments, quantities and unit prices. Costs will change with further design. Time value-of-money escalation costs are not included. A construction schedule is not available at this time. Contingency is an allowance for the net sum of costs that will be in the Final Total Project Cost at the time of the completion of design, but are not included at this level of project definition. The estimated accuracy range for the Total Project Cost as the project is defined is -20% to +30%. The accuracy range is based on professional judgement considering the level of design completed, the complexity of the project and the uncertainties in the project as scoped. The contingency and the accuracy range are not intended to include costs for future scope changes that are not part of the project as currently scoped or costs for risk contingency. Operation and Maintenance costs are not included.
 - ⁶ Estimate assumes projects will not be located on contaminated soil.
 - ⁷ Estimate costs are to design, construct, and permit each alternative. The estimated costs do not include maintenance, monitoring or additional tasks following construction.
 - ⁸ Estimate costs are reported to nearest thousand dollars.